

# **CERAMIC GRINDING WHEELS**

- **HIGH PERFORMANCE CERAMIC ALUMINUM OXIDE**
- **UP TO 5X LONGER LIFE THAN WHITE ALUMINUM OXIDE WHEELS**
- **SUPERIOR STOCK REMOVAL RATES, LONG WHEEL LIFE REDUCING GRINDING COSTS**
- **MAXIMUM RESULTS FOR:**
  - TOOL SHARPENING**  
HSS & TOOL STEEL <68 HRC
  - SURFACE GRINDING**  
HSS & TOOL STEEL <68 HRC, 300 & 400 SERIES STAINLESS STEEL, CAST IRON: DUCTILE & GRAY, NONFERROUS ALLOYS

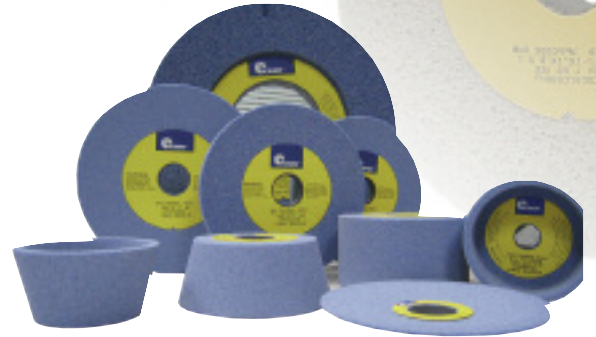

## KINIK CERAMIC GRINDING WHEELS

### Peripheral Surface Grinding

Surface grinding with straight or recessed wheels on machines with a rotating or reciprocating table results in a larger contact area than in cylindrical grinding. Therefore it is necessary to use softer grade wheels, particularly when large diameter and/or wide wheels are used.

When grinding a large number of components, the grinding is not continuous. In this case the components tend to dress the wheel, so a harder grade wheel should be used.



### KINIK SURFACE GRINDING WHEELS

Dimensions	Structure		Structure		Structure		Structure	
	CSKG 46H	Price \$	CSKG 46K	Price \$	CSKG 60K	Price \$	CSKG 80K	Price \$
6x1/2x1-1/4					635-046	19.30		
7x1/4x1-1/4			635-047	23.80	635-048	23.00	635-049	23.00
7x1/2x1-1/4			635-055	24.90	635-050	24.90	635-053	24.90
8x1/4x1-1/4					635-061	27.10		
8x1/2x1-1/4			635-064	32.90	635-065	32.90	635-066	32.90
8x3/4x1-1/4			635-067	41.20	635-068	41.20		
8x1x1-1/4			635-069	47.10	635-071	47.10		
10x1x3			635-072	68.10	635-073	68.10		
12x3/4x3			635-074	93.80				
12x1x3			635-076	98.90	635-077	98.90	635-078	98.20
12x1x5			635-079	98.10	635-081	98.20		
12x1-1/2x5			635-082	123.50				
14x1x5			635-083	123.50	635-084	128.00		
14x1-1/2x5			635-086	157.90	635-087	157.90		
<b>RECESSED 2A BOTH SIDES</b>								
14x2x5	2A 8x3/8		635-088	213.60	635-089	213.60		
14x2x5	2A 8x3/8 H	635-070	221.60					



### KINIK CERAMIC CUP WHEELS

#### Shape D Straight Cup

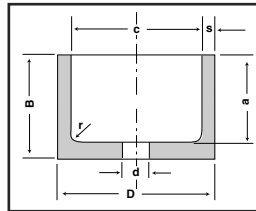

#### KINIK CERAMIC STRAIGHT CUP WHEELS

D	B	d	a	c	r	s	CSKG60J	Price \$	CSKG60K	Price \$
4	2	20mm	1-9/16	3-1/2	3/16	1/4	635-075	34.40		
5	2-1/2	1-1/4	2	4-5/16	1/4	5/16			635-080	43.10

#### KINIK CERAMIC SHAPE B SAUCER TYPE

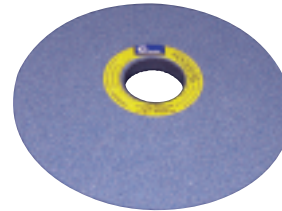
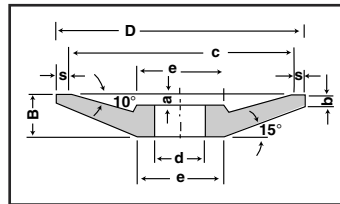

#### KINIK CERAMIC SHAPE B SAUCER TYPE

D	B	d	a	b	c	e	s	CSKG60K	Price \$
6	5/8	1-1/4	1/4	1/8	5-3/8	2	5/16	635-095	46.40

#### KINIK CERAMIC SHAPE E FLARING CUP

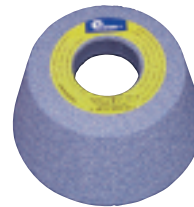
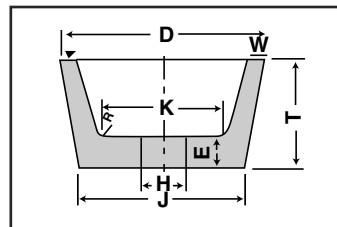

#### KINIK CERAMIC SHAPE E FLARING CUP

D	T	H	W	E	J	K	CSKG60K	Price \$
4	2	1-1/4	6 mm	1/2	3	2-1/2	635-085	34.40
5	2	1-1/4	8 mm	1/2	4	3	635-090	46.40