

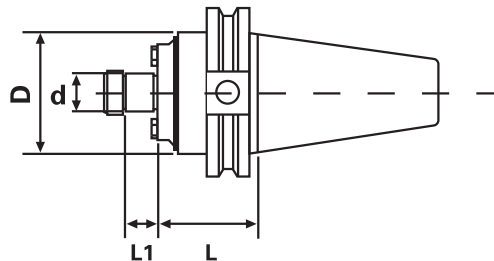

**CNC**  
Tooling

### BT TAPER SHELL MILL HOLDERS

- Shank traverse ground to obtain optimum accuracy
- Meets or exceeds ANSI specifications
- .0002" or better ensures the best possible cutting tool life

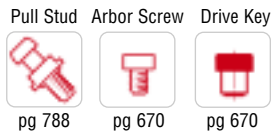

BT 30 & BT 40 TAPER SHELL MILL HOLDERS								
Taper	d	L	D	L1	Key Size	Arbor Thread	Code No.	Price \$
BT30	1/2"	1.19"	1.38"	0.57"	1/4"	1/4"-28	532-080	129.30
	3/4"	1.19"	2.00"	0.67"	5/16"	3/8"-24	532-082	129.30
	1"	1.19"	2.38"	0.67"	3/8"	1/2"-20	532-084	129.30
BT40	1/2"	1.75"	1.38"	0.57"	1/4"	1/4"-28	532-086	136.00
	3/4"	1.75"	2.00"	0.67"	5/16"	3/8"-24	532-088	136.00
	1"	1.75"	2.38"	0.67"	3/8"	1/2"-20	532-090	136.00
	1-1/4"	2.00"	2.88"	0.67"	1/2"	5/8"-18	532-092	136.00
	1-1/2"	2.00"	3.80"	0.92"	5/8"	3/4"-16	532-094	136.00

### SHELL END MILL ARBORS

#### BT50 SHANK

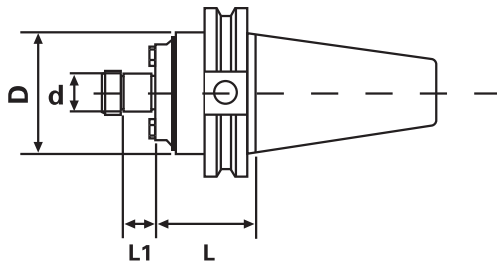

BT 50 SHELL MILL ARBORS								
Taper	d	L	D	L1	Key Size	Arbor Thread	Code No.	Price \$
BT50	1.00	1.75	2.75	0.69	3/8	1/2-20	532-101	162.70
BT50	1.25	1.75	2.88	0.69	1/2	5/8-18	532-103	174.30
BT50	1.50	1.75	3.80	0.92	5/8	3/4-16	532-105	136.00
BT50	2.00	2.00	4.38	0.92	3/4	1"-14	532-107	193.30