



CNC Tooling

CAT TAPER TG COLLET CHUCKS

- Shank traverse ground to obtain optimum accuracy
- Meets or exceeds ANSI specifications
- .0002" or better ensures the best possible cutting tool life
- Wrench not included
- **Factory Balanced to save spindle life, tool life and increased productivity**
- Threaded through holes for a back-up screw (tool stop) or coolant through when removed



Each holder comes complete with certificate

CAT 40	CAT 50	Pull Stud	Nut	Wrench	TG Collet
20x RPMs	15x RPMs				
		pg 788	pg 707	pg 707	pg 702

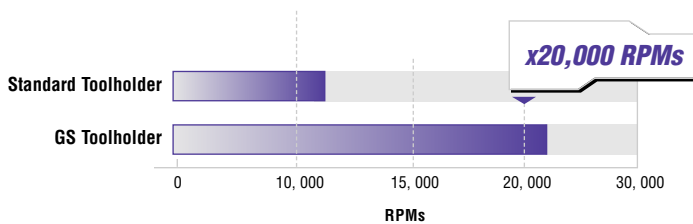
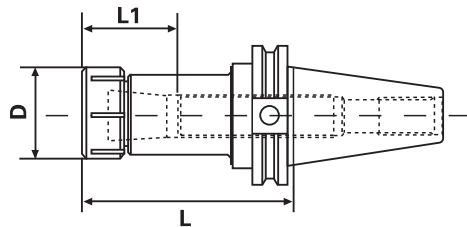

CAT TAPER TG COLLET CHUCKS							
Taper	Collet Series	Collet Range	L	L1	D	Code No.	Price \$
CT40	75TG	3/64-3/4"	3.00"	1.61"	1.89"	531-284	109.40
	75TG	3/64-3/4"	5.00"	1.61"	1.89"	531-286	142.50
CT40	100TG	3/64-1"	3.00"	2.13"	2.50"	531-288	109.70
	100TG	3/64-1"	3.50"	2.13"	2.50"	531-290	109.70
	100TG	3/64-1"	5.50"	2.13"	2.50"	531-292	142.50
CT40	150TG	1/2-1-1/2"	6.00"	2.88"	3.50"	531-294	163.80
CT50	75TG	3/64-3/4"	3.50"	1.61"	1.89"	531-296	134.70
	75TG	3/64-3/4"	5.50"	1.61"	1.89"	531-298	169.30
CT50	100TG	3/64-1"	3.50"	2.13"	2.50"	531-300	134.70
	100TG	3/64-1"	5.50"	2.13"	2.50"	531-302	177.70
	100TG	3/64-1"	7.50"	2.13"	2.50"	531-304	195.00
	100TG	3/64-1"	10.00"	2.13"	3.50"	531-306	212.30
CT50	150TG	1/2-1-1/2"	3.50"	2.88"	3.50"	531-308	183.30
	150TG	1/2-1-1/2"	6.00"	2.88"	3.50"	531-310	192.00

TG BT/NMTB COLLET CHUCKS



CNC Tooling

BT TAPER TG COLLET CHUCKS

- Shank traverse ground to obtain optimum accuracy
- Meets or exceeds ANSI specifications
- .0002" or better ensures the best possible cutting tool life
- Wrench not included
- **Factory Balanced to save spindle life, tool life and increased productivity**
- Threaded through holes for a back-up screw (tool stop) or coolant through when removed

Each holder comes complete with certificate

BT 30/40	BT 50	Pull Stud	Nut	Wrench	TG Collet
20x RPMs	15x RPMs				
		pg 788	pg 707	pg 707	pg 702

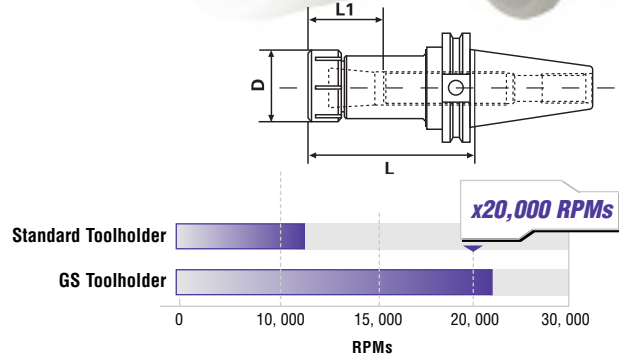

BT TAPER TG COLLET CHUCKS

Taper	Collet Series	Collet Range	L	L1	D	Code No.	Price \$
BT30	75TG	3/64-3/4"	2.50"	1.61"	1.89"	532-128	99.00
BT30	100TG	3/64-1"	3.94"	2.24"	2.50"	532-130	99.00
BT40	75TG	3/64-3/4"	3.00"	1.61"	1.89"	532-132	109.70
BT40	100TG	3/64-1"	3.50"	2.13"	2.50"	532-134	109.70
BT40	100TG	3/64-1"	5.50"	2.13"	2.50"	532-136	142.50
BT40	150TG	1/2-1-1/2"	5.50"	2.87"	3.50"	532-138	170.80
BT50	100TG	3/64-1"	4.00"	2.13"	2.50"	532-139	134.70
BT50	100TG	3/64-1"	6.00"	2.13"	2.50"	532-140	177.70
BT50	150TG	1/2-1-1/2"	4.00"	2.87"	2.87"	532-141	174.50

Standard

Tooling

NMTB TAPER TG COLLET CHUCKS

Nut	Wrench	TG Collet
pg 707	pg 707	pg 702

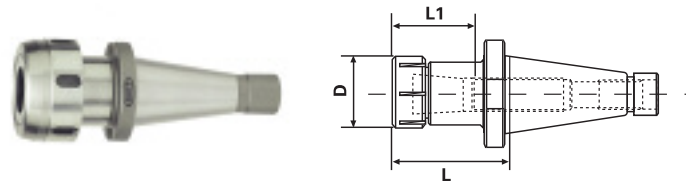

NMTB TAPER TG COLLET CHUCKS

Taper	Collet Series	Collet Range	L	L1	D	Code No.	Price \$
NMTB40	75TG	3/64-3/4"	2.50"	1.61"	1.89"	534-302	104.30
NMTB40	100TG	3/64-1"	3.00"	2.12"	2.50"	534-304	104.30
NMTB40	150TG	1/2-1-1/2"	5.00"	2.87"	3.50"	534-306	108.40
NMTB50	75TG	3/64-3/4"	3.00"	1.61"	1.89"	534-308	146.10
NMTB50	100TG	3/64-1"	3.50"	2.12"	2.50"	534-310	166.70
NMTB50	150TG	1/2-1-1/2"	5.00"	2.87"	3.50"	534-312	184.10