

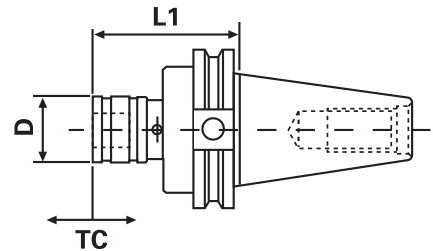

## CNC Tooling

### CAT TAPER TENSION/COMPRESSION TAP HOLDERS

- Quick-change - push back on the holder sleeve and the adapter with tool is removable
- Press on the end of the adapter nose and the tool is removable - all in a few seconds.
- Smooth stroke - even under full torque load, the tension-compression stroke is full and free.
- Interchangability - our adapters and holders are interchangeable with Universal-Bilz quick change holders and adapters

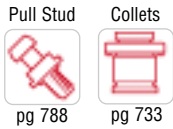

CAT TAPER TENSION/COMPRESSION TAP HOLDERS									
Taper	Tap Range Hand	Tap Range Pipe	System	L	D	T	C	Code No.	Price \$
CT40	#0-9/16"	1/8"	#1	4.00"	1.43"	0.29"	0.29"	531-540	<b>310.80</b>
	#0-9/16"	1/8"	#1	4.47"	1.25"	0.79"	0.39"	531-542	<b>326.40</b>
CT40	5/16-7/8"	1/4-1/2"	#2	4.50"	2.09"	0.49"	0.49"	531-544	<b>369.20</b>
	5/16-7/8"	1/4-1/2"	#2	6.66"	2.00"	0.85"	0.49"	531-546	<b>377.10</b>
CT40	13/16-1-3/8"	3/4-1"	#3	8.00"	3.07"	0.79"	0.79"	531-548	<b>492.80</b>
	13/16-1-3/8"	3/4-1"	#3	9.19"	2.87"	0.98"	0.59"	531-550	<b>506.80</b>
CT50	#0-9/16"	1/8"	#1	4.00"	1.43"	0.29"	0.29"	531-552	<b>367.00</b>
	#0-9/16"	1/8"	#1	5.02"	1.25"	0.79"	0.39"	531-554	<b>385.20</b>
CT50	5/16-7/8"	1/4-1/2"	#2	4.50"	2.09"	0.49"	0.49"	531-556	<b>502.20</b>
	5/16-7/8"	1/4-1/2"	#2	5.66"	2.00"	0.85"	0.49"	531-558	<b>502.60</b>
CT50	13/16-1-3/8"	3/4-1"	#3	6.25"	3.07"	0.79"	0.79"	531-560	<b>672.70</b>
	13/16-1-3/8"	3/4-1"	#3	7.72"	2.87"	0.98"	0.59"	531-562	<b>705.90</b>

## CNC Tooling

### CT TAPER RIGID TAP HOLDERS

- Quick-Change - push back on the holder sleeve and the adapter with tool is removable
- Press on the end of the adapter nose and the tool is removable - all in a few seconds.
- Smooth Stroke - even under full torque load, the tension-compression stroke is full and free.
- Interchangability - our adapters and holder are interchangeable with Universal-Bilz quick change holders and adapters

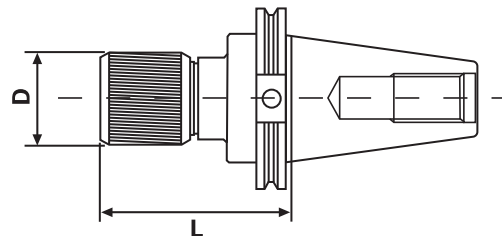
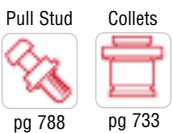

CAT TAPER RIGID TAP HOLDERS							
Taper	Tap Range Hand	Tap Range Pipe	System	L	D	Code No.	Price \$
CT40	#0-9/16"	1/8"	#1	3.02"	1.25"	531-564	<b>147.30</b>
	5/16-7/8"	1/4-1/2"	#2	3.66"	2.00"	531-566	<b>175.10</b>
	13/16-1-3/8"	3/4-1"	#3	4.72"	2.87"	531-568	<b>200.40</b>
CT50	#0-9/16"	1/8"	#1	3.02"	1.25"	531-570	<b>210.60</b>
	5/16-7/8"	1/4-1/2"	#2	3.91"	2.00"	531-572	<b>222.00</b>
	13/16-1-3/8"	3/4-1"	#3	4.98"	2.87"	531-574	<b>338.30</b>