



CNC Tooling

CAT MORSE TAPER ADAPTERS

- Shank traverse ground to obtain optimum accuracy
- Meets or exceeds ANSI specifications
- .0002" or better ensures the best possible cutting tool life

Pull Stud



pg 788

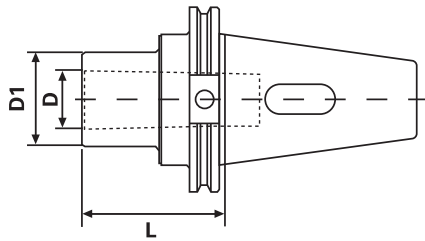

■ CAT MORSE TAPER ADAPTERS

Taper	Size	L	D	D1	Code No.	Price \$
CT40	MT#1	1.75"	.475"	1.00"	531-510	110.30
CT40	MT#2	2.36"	.700"	1.25"	531-512	110.30
CT40	MT#3	3.00"	.938"	1.57"	531-514	110.30
CT40	MT#4	3.54"	1.23"	1.97"	531-516	110.30
CT50	MT#2	1.75"	.700"	1.25"	531-518	150.40
CT50	MT#3	1.75"	.938"	1.57"	531-520	162.40
CT50	MT#4	3.00"	1.23"	1.97"	531-522	162.40
CT50	MT#5	4.13"	1.75"	2.75"	531-524	182.90

BT MORSE TAPER ADAPTERS

- Shank traverse ground to obtain optimum accuracy
- Meets or exceeds ANSI specifications
- .0002" or better ensures the best possible cutting tool life

Pull Stud



pg 788

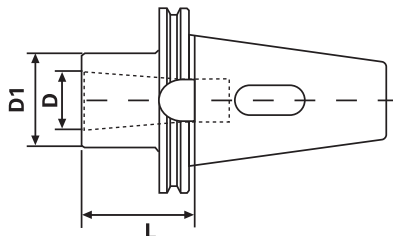

■ BT MORSE TAPER ADAPTERS

Taper	Size	L	D	D1	Code No	Price \$
BT30	MT#1	1.75"	.475"	1.00"	532-238	99.80
BT30	MT#2	2.36"	.700"	1.25"	532-240	99.80
BT40	MT#1	1.75"	.475"	1.00"	532-242	110.30
BT40	MT#2	2.36"	.700"	1.25"	532-244	110.30
BT40	MT#3	3.00"	.938"	1.57"	532-246	110.30
BT40	MT#4	3.54"	1.23"	1.97"	532-248	110.30
BT50	MT#2	1.75"	.700"	1.25"	532-241	150.40
BT50	MT#3	1.75"	.928"	1.57"	532-243	162.20
BT50	MT#4	3.00"	1.231"	1.89"	532-245	162.40
BT50	MT#5	4.00"	1.748"	2.48"	532-247	182.90