



EXTENSION LENGTH SOCKETS

| ■ EXTENSION LENGTH SOCKETS | | | | | | | |
|----------------------------|------------------|-------------------|----------------|-----------------------------------|----------|--------------------------------------|----------|
| Sleeve No. | Morse Taper Hole | Morse Taper Shank | Length Overall | Soft, Hardened Tang Only Code No. | Price \$ | Hardened and Ground Thruout Code No. | Price \$ |
| 21 | 2 | 1 | 6-1/4 | 420-405 | 69.10 | 420-605 | 28.70 |
| 12 | 1 | 2 | 6-1/4 | 420-410 | 66.10 | 420-610 | 28.70 |
| 22 | 2 | 2 | 6-7/8 | 420-415 | 62.40 | 420-615 | 31.76 |
| 32 | 3 | 2 | 7-3/4 | 420-420 | 72.20 | 420-620 | 42.56 |
| 42 | 4 | 2 | 8-1/2 | 420-425 | 129.30 | 420-625 | 59.00 |
| 13 | 1 | 3 | 6-7/8 | 420-430 | 33.10 | 420-630 | 33.10 |
| 23 | 2 | 3 | 7-5/8 | 420-435 | 74.70 | 420-635 | 33.10 |
| 33 | 3 | 3 | 8-1/2 | 420-440 | 76.20 | 420-640 | 48.93 |
| 43 | 4 | 3 | 9-1/2 | 420-445 | 104.20 | 420-645 | 64.80 |
| 53 | 5 | 3 | 10-1/2 | 420-450 | 172.00 | 420-650 | 123.00 |
| 14 | 1 | 4 | 7-1/2 | 420-455 | 99.80 | 420-655 | 48.20 |
| 24 | 2 | 4 | 8-1/2 | 420-460 | 82.40 | 420-660 | 47.10 |
| 34 | 3 | 4 | 9-1/2 | 420-465 | 89.30 | 420-665 | 43.64 |
| 44 | 4 | 4 | 10-1/2 | 420-470 | 119.00 | 420-670 | 66.96 |
| 54 | 5 | 4 | 11-7/8 | 420-475 | 164.30 | 420-675 | 127.88 |
| 35 | 3 | 5 | 10-1/2 | 420-480 | 112.60 | 420-680 | 78.70 |
| 45 | 4 | 5 | 11-7/8 | 420-485 | 130.10 | 420-685 | 122.50 |
| 55 | 5 | 5 | 13-1/4 | 420-490 | 189.20 | 420-690 | 137.81 |
| 65 | 6 | 5 | 15-3/8 | 420-495 | 318.40 | 420-695 | 281.13 |
| 46 | 4 | 6 | 14 | 420-500 | 218.70 | 420-700 | 191.90 |
| 56 | 5 | 6 | 15-3/8 | 420-505 | 260.90 | 420-705 | 203.15 |

SOLID SOCKETS

Hardened and Ground Throughout

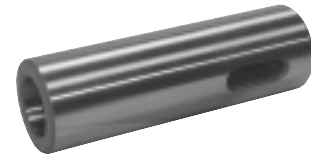

| ■ SOLID SOCKETS | | | | | |
|-----------------|----------------------|------------------|--------------------|----------|----------|
| Socket No. | Length Overall (in.) | Morse Taper Hole | Outside Dia. (in.) | Code No. | Price \$ |
| 1 | 3-1/2 | 1 | 1 | 420-805 | 57.40 |
| 2 | 3-1/2 | 1 | 1-1/4 | 420-810 | 61.10 |
| 3 | 3-1/2 | 1 | 1-1/2 | 420-815 | 69.90 |
| 4 | 4 | 2 | 1 | 420-820 | 78.90 |
| 5 | 4 | 2 | 1-1/4 | 420-825 | 78.90 |
| 6 | 4 | 2 | 1-1/2 | 420-830 | 78.90 |
| 7 | 4 | 2 | 1-3/4 | 420-835 | 78.90 |
| 8 | 4 | 2 | 2 | 420-840 | 91.90 |
| 9 | 4-3/4 | 3 | 1-1/4 | 420-845 | 85.60 |
| 10 | 4-3/4 | 3 | 1-1/2 | 420-850 | 85.60 |
| 11 | 4-3/4 | 3 | 1-3/4 | 420-855 | 85.60 |
| 12 | 4-3/4 | 3 | 2 | 420-860 | 97.50 |
| 13 | 6 | 4 | 1-1/2 | 420-865 | 107.00 |
| 14 | 6 | 4 | 1-3/4 | 420-870 | 107.00 |
| 15 | 6 | 4 | 2 | 420-875 | 121.40 |
| 16 | 7-3/8 | 5 | 2-1/4 | 420-880 | 180.30 |
| 17 | 7-3/8 | 5 | 2-1/2 | 420-885 | 180.30 |
| 18 | 10-1/8 | 6 | 3-1/4 | 420-890 | 322.20 |
| 19 | 10-1/8 | 6 | 3-1/2 | 420-895 | 328.90 |