



5C SPIN INDEX

Accepts 5C Collets to 1-1/8" Capacity

A multi-purpose accessory

- Vernier setting to 1 degree
- 2-1/16" spindle travel for flute grinding
- Index plate has precise (10°) 36 hole circle

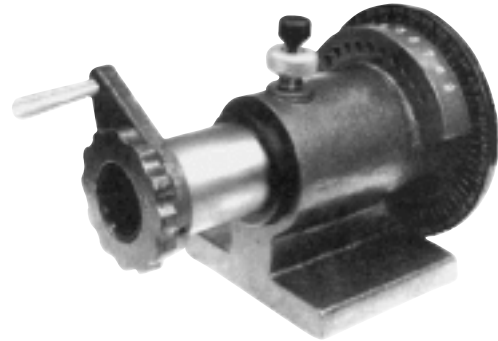

Specifications	Max. Variation Inches
True running of dividing spindle flange surface	0.0004"
True running of cylindrical centre bore per 1"	0.0012"
Parallelism of spindle centre line to base	0.0008"

5C SPIN INDEX		
Model No.	Code No.	Price \$
C1-310	326-110	107.40

5C COLLET INDEX

Horizontal/Vertical 5C Collet Index

The Spindle has a taper seat in the body frame. Rapid opening and closing of the collet on a production basis is done with the lever collet closer having a leverage ratio of 100 to 1. A ratchet device on the front of the spindle permits rapid rotation of the spindle nose. The index plate has a screw in each of the 24 index holes so that holes not required for a particular job can be masked. Threaded spindle 2-1/4" - 8TPI.



Specifications	Max. Variation Inches
True running of axis for dividing spindle	0.0004"
True running of cylindrical centre bore per 1"	0.0012"
Parallelism of spindle centre line to base	0.0008"
Squareness of base angle face	0.0008"
Parallelism of centre slot to dividing spindle	0.0008"
Lateral offset of centre slot to dividing spindle	0.0008"

5C COLLET INDEX		
Model No.	Code No.	Price \$
C1-108	326-108	692.90

5C COLLET

- Made of tool steel, hardened and ground to maintain original accuracy

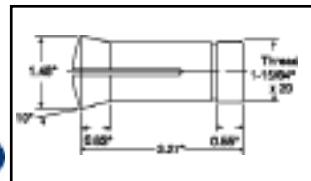

5C COLLETS				
Size	GS		STM	
	Code No.	Price \$	Code No.	Price \$
1/8	325-317	20.70	325-315	10.40
3/16	325-322	20.70	325-320	10.40
1/4	325-327	20.70	325-325	10.40
5/16	325-332	20.70	325-330	10.40
3/8	325-337	20.70	325-335	10.40
7/16	325-342	20.70	325-340	10.40
1/2	325-347	20.70	325-345	10.40

Size	GS		STM	
	Code No.	Price \$	Code No.	Price \$
9/16	325-354	20.70	325-350	10.40
5/8	325-357	20.70	325-355	10.40
11/16	325-362	20.70	325-360	10.40
3/4	325-367	20.70	325-365	10.40
13/16	325-372	20.70	325-370	10.40
7/8	325-377	20.70	325-375	10.40
15/16	325-382	20.70	325-380	10.40
1	325-387	20.70	325-385	10.40
5C Collet Set 1/8-1"	325-310	157.30		