

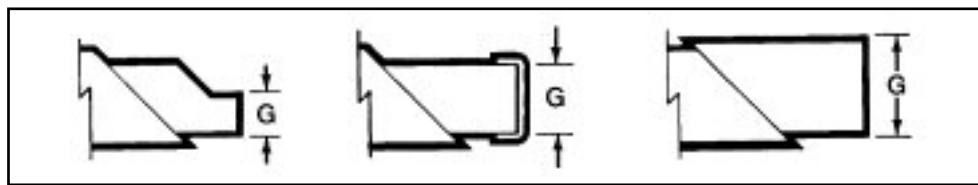

## NUZZLER® EDGE CLAMPS

- Black oxide finish
- Noses have serrations for better gripping of non-finished or semi-finished workpieces
- Edge clamps feature a double action, adjustable nose which exerts clamping pressures both downward and inward through a 45° angle

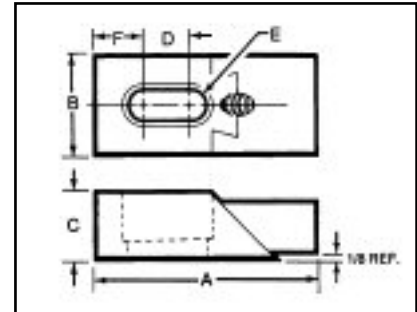
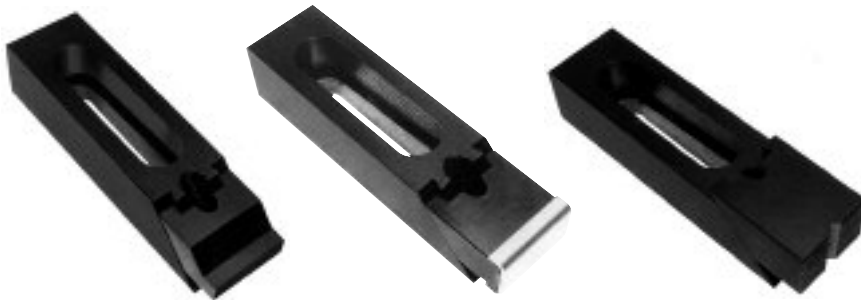

Low Grip (Style L)

Standard Grip (Style S)

High Grip (Style H)

■ NUZZLER® EDGE CLAMPS												
A	B	C	D	E	F	Nose Style	G	Wrench Size	Weight (lbs/100)	Model No.	Code No.	Price \$
1-7/8	1	5/8	1/4	5/16	13/32	L	1/8	5/32	25	33817	608-200	70.60
2-3/8	1	5/8	3/4	5/16	5/16	L	1/8	5/32	29	33819	608-201	73.20
2-7/8	1	5/8	1-1/4	5/16	5/16	L	1/8	5/32	35	33821	608-202	77.90
2-5/16	1-1/4	5/8	3/8	3/8	7/16	L	1/8	5/32	38	33801	608-203	72.30
2-3/4	1-1/4	5/8	13/16	3/8	1/2	L	1/4	3/16	44	33890	608-204	77.90
4-1/8	1-1/4	5/8	2	3/8	1-1/16	L	1/4	3/16	63	33803	608-205	80.30
4-11/16	1-1/4	5/8	2-3/16	3/8	15/16	L	1/4	3/16	73	33892	608-206	82.50
3-5/16	1-1/2	3/4	3/4	1/2	11/16	L	3/8	1/4	81	33805	608-207	82.20
5-3/16	1-1/2	3/4	2-1/2	1/2	5/8	L	3/8	1/4	117	33807	608-208	86.50
3-7/8	1-1/2	7/8	1-1/4	1/2	1/2	L	1/4	1/4	100	33823	608-209	77.90
5-5/16	1-1/2	7/8	2	1/2	7/8	L	1/4	1/4	141	33825	608-210	84.30
7-1/4	1-1/2	7/8	3	1/2	1-3/8	L	1/4	1/4	189	33827	608-211	90.90
5-13/16	1-1/2	1-1/4	2-1/4	1/2	1-1/16	L	3/8	1/4	207	33809	608-212	136.00
7-1/8	1-1/2	1-1/4	3-5/16	1/2	1-3/16	L	3/8	1/4	252	33812	608-213	140.00
5-1/4	2	1-1/4	1-3/8	3/4	27/32	L	3/8	5/16	235	33829	608-214	217.60
1-7/8	1	5/8	1/4	5/16	13/32	S	5/8	5/32	30	33818	608-215	73.20
2-3/8	1	5/8	3/4	5/16	5/16	S	5/8	5/32	35	33820	608-216	80.30
2-7/8	1	5/8	1-1/4	5/16	5/16	S	5/8	5/32	40	33822	608-217	82.50
2-5/16	1-1/4	5/8	3/8	3/8	7/16	S	5/8	3/16	43	33802	608-218	77.90
2-3/4	1-1/4	5/8	13/16	3/8	1/2	S	5/8	3/16	49	33891	608-219	82.50
4-1/8	1-1/4	5/8	2	3/8	11/16	S	5/8	3/16	73	33804	608-220	85.10
4-11/16	1-1/4	5/8	2-3/16	3/8	15/16	S	5/8	3/16	76	33893	608-221	86.90
3-5/16	1-1/2	3/4	3/4	1/2	11/16	S	3/4	1/4	88	33806	608-222	88.10
5-3/16	1-1/2	3/4	2-1/2	1/2	5/8	S	3/4	1/4	123	33808	608-223	90.90
3-7/8	1-1/2	7/8	1-1/4	1/2	1/2	S	7/8	1/4	112	33824	608-224	84.30
5-5/16	1-1/2	7/8	2	1/2	7/8	S	7/8	1/4	155	33826	608-225	88.70
7-1/4	1-1/2	7/8	3	1/2	1-3/8	S	7/8	1/4	205	33828	608-226	96.90
5-13/16	1-1/2	1-1/4	2-1/4	1/2	1-1/16	S	3/4	1/4	216	33810	608-227	146.60
7-1/8	1-1/2	1-1/4	3-5/16	1/2	1-3/16	S	3/4	1/4	255	33813	608-228	151.10
6-1/8	1-1/2	1-1/4	2-1/4	1/2	1-1/16	H	1	1/4	240	33811	608-229	157.70
7-3/8	1-1/2	1-1/4	3-5/16	1/2	1-3/16	H	1	1/4	286	33814	608-230	162.10
5-1/4	2	1-1/4	1-3/8	3/4	27/32	H	1-1/4	5/16	296	33815	608-231	209.50
6-7/16	2-1/2	1-1/2	2	7/8	15/16	H	1-1/2	1/2	541	33816	608-232	320.40