



Multi-functional 45° Chamfer Tool



- Uses**
- Centering
 - Grooving
 - Chamfering

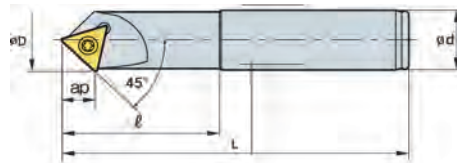

Fig. 1

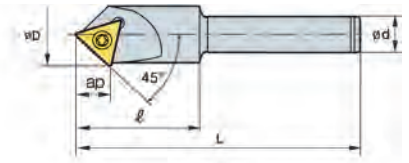



Fig. 2

*AR: -12~15° (inch)

Designation	Code No.	Price \$	ØD	Ød	ℓ	L	ap	Fig.	Insert
CTP45 1600R-S050	147543	241.09	0.87	0.50	1.6	3.5	0.4	2	
CTP45 1600R-S075	147548	208.11	0.87	0.75	2.0	4.5	0.4	1	TWX16R-KC
CTP45 1600R-L075	147552	197.92	0.87	0.75	2.4	8.0	0.4	1	
CTP45 2200R-S050	147930	275.58	1.14	0.50	1.6	3.5	0.6	2	
CTP45 2200R-S100	147931	231.81	1.14	1.00	2.0	4.5	0.6	1	TWX22R-KC
CTP45 2200R-L100	147932	232.45	1.14	1.00	2.4	8.0	0.6	1	

Available Insert

TWX	Designation
	TWX16R-KC TWX22R-KC

Parts

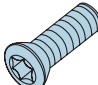
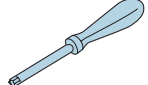
Screw	Wrench
	
FTNA0408 146948 \$ 9.04	TW15L 148225 \$ 3.39

Indexable Chamfer Tool



- Designed for large chamfers and countersinking
- 1" shank

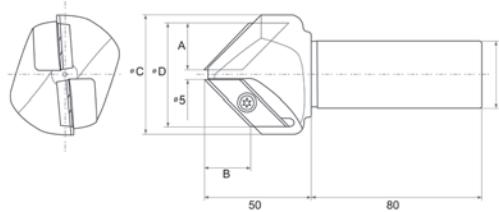

Model No.	Angle	Dia. Range (mm)	A (mm)	B (mm)	ØC (mm)	ØD (mm)	d (mm)	Inserts	Code No.	Price \$
CSC05031R-41-A	82°	6-42.9	19.0	21.8	56	42.9	25.4	2	149096	589.06
CSC05031R-45-A	90°	6-46.9	21.0	21.0	56	46.9	25.4	2	149097	589.06

Insert

- SCW200 - TiN coated carbide grade for heavier duty applications
 SCW300 - TiAlN coated carbide for higher speed applications

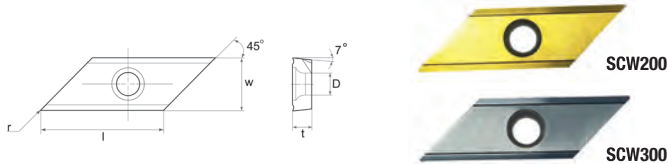

Model No.	l (mm)	w (mm)	t (mm)	D (mm)	r (mm)	Code No.	Price \$
XCET310404 ER SCW200	22.0	12.70	4.50	5.60	0.4	149094	118.73
XCET310404 ER SCW300	22.0	12.70	4.50	5.60	0.4	149095	127.85