

Replacement Drive Keys



Spigot Dia.	Description	Code No.	Price \$
1/2	Two 1/4 Drive keys	534164	21.01
3/4	Two 5/16	534166	24.72
1	Two 3/8	534168	30.36
1-1/4	Two 1/2	534170	33.53
1-1/2	Two 5/8	534172	36.35
2	Two 3/4	534174	44.69
2-1/2	Two 1	534176	38.36

Replacement Arbor Screws



Thread Size	Size of Holder	Code No.	Price \$
5/8-11	Face Mill Mounting Bolt	534178	19.67
1/4-28	1/2	534180	19.67
3/8-24	3/4	534182	20.54
1/2-20	1	534184	23.69
5/8-18	1-1/4	534186	26.85
3/4-16	1-1/2	534188	41.57
1-14	2	534190	58.91

Shell End Mill Arbors For Morse Taper Spindles



Style "B" with Draw Bar End
Style "A" with Tang End

Machined from one piece forgings, hardened and precisely ground; hardness 52-56 HRC. Maximum misalignment of taper in shank, in which the tool is fixed: 0.0006". The drive keys are pressed in.

- Draw bar threads for #4 MT: 1/2"-13
- Draw bar threads for #5 MT: 5/8"-11

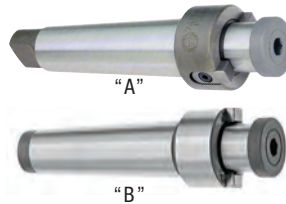

Draw Bar Arbor No.	M.T.	For Bore Dia.	Dia. for Range of Shell End Mill	Style "B" Draw Bar End Code No.	Price \$	Style "A" Tang End Code No.	Price \$
MT4-1/2	4	1/2	1-1/4 to 1-1/2	410405	277.67	410305	355.63
MT4-3/4	4	3/4	1-3/4 to 2	410410	292.15	410310	424.70
MT4-1	4	1	2-1/4 to 2-3/4	-	-	410315	453.66
MT4-1-1/4	4	1-1/4	3 to 3-1/2	-	-	410320	514.80
MT4-1-1/2	4	1-1/2	4 to 5	-	-	410325	540.53
MT5-1-1/4	5	1-1/4	3 to 3-1/2	410435	402.32	410335	518.48
MT5-1-1/2	5	1-1/2	4 to 5	-	-	410340	575.92

CAT Taper Stub Arbors



- Each arbor equipped with 1/8, 1/4, 3/8, 1/2 spacers

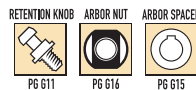
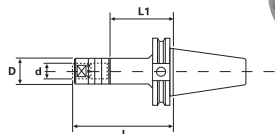

Taper	d	L	D	L1	Code No.	Price \$
CAT40						
CT40	1	6.17	1.50	4.00	531580	229.04
CT40	1-1/4	6.29	1.75	4.00	531582	234.02
CT40	1-1/2	6.60	2.12	4.00	531584	250.47
CAT50						
CT50	1	6.17	1.50	4.00	531586	341.24
CT50	1-1/4	6.28	1.75	4.00	531588	361.85
CT50	1-1/2	6.60	2.12	4.00	531590	372.71

Face Mill Holders



Made of selected steel, hardened and precision ground
• These holders have 4 mounting holes and bolts with 5/8-11 threads on a 4" bolt circle



Taper	Fore Bore Dia.	Length of Arbor	Screw Size	Code No.	Price \$
ISA40	2	6.20	5/8-11	410190	1,225.86
ISA40	2-1/2	6.20	5/8-11	410192	1,216.21
ISA50	2	7.56	5/8-11	410194	1,331.28
ISA50	2-1/2	7.56	5/8-11	410196	1,370.65
MT 5	2	9.57	5/8-11	410202	1,961.60
MT 5	2-1/2	9.57	5/8-11	410204	2,023.79
MT 6	2	13.58	5/8-11	410206	2,158.74
MT 6	2-1/2	13.58	5/8-11	410208	2,532.15

Replacement Stub Arbor Spacers



Description	Code No.	Price \$
1/8" Spacer for 3/4" Holder	534568	15.01
1/4" Spacer for 3/4" Holder	534570	15.01
3/8" Spacer for 3/4" Holder	534572	15.01
1/2" Spacer for 3/4" Holder	534574	15.01
1/8" Spacer for 1" Holder	534576	15.34
3/8" Spacer for 1" Holder	534580	15.34
1/8" Spacer for 1-1/4" Holder	534584	16.06
3/8" Spacer for 1-1/4" Holder	534588	16.68
1/8" Spacer for 1-1/2" Holder	534592	17.36
3/8" Spacer for 1-1/2" Holder	534596	16.71
1/2" Spacer for 1-1/2" Holder	534598	16.71

Slitting Saw Arbor



Diameter of Arbor (in.)	Length (in.)	Fits Following Hole Size (in.)	Code No.	Price \$
1/2	2-9/16	1/2, 5/8, 3/4, 7/8, 1	400150	115.53

R8 Stub Milling Machine Arbor



To fit Bridgeport and other popular machines. Furnished complete with assorted spacers.



Arbor No.	Arbor Dia. (in.)	Length of Shoulder to Nut (in.)	Thread of Nut	Code No.	Price \$
R8S1	1	2	1 - 14	400350	588.81