

NMTB Taper TG Collet Chucks

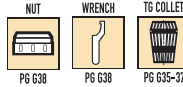

| Taper | Collet Series | Collet Range | L | L1 | D | Tightening Torque (Nm) | Code No. | Price \$ |
|--------|---------------|--------------|------|------|------|------------------------|----------|----------|
| NMTB40 | TG100 | 3/64-1 | 3.00 | 2.12 | 2.50 | 81.3 | 534304 | 161.15 |
| NMTB50 | TG75 | 3/64-3/4 | 3.00 | 1.61 | 1.89 | 81.3 | 534308 | 195.02 |
| NMTB50 | TG100 | 3/64-1 | 3.50 | 2.12 | 2.50 | 81.3 | 534310 | 257.62 |

R8 Taper TG Collet Chuck

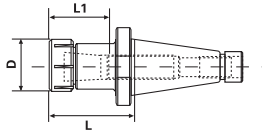
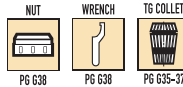
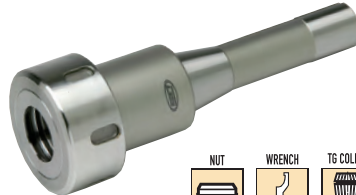
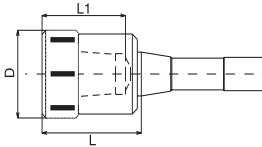

| Taper | Collet Series | Collet Range | L | L1 | D | Tightening Torque (Nm) | Code No. | Price \$ |
|-------|---------------|--------------|------|------|------|------------------------|----------|----------|
| R8 | TG100 | 3/64-1 | 3.25 | 2.17 | 2.50 | 81.3 | 534314 | 174.96 |

Morse Taper TG Collet Chucks

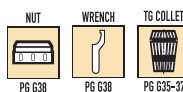
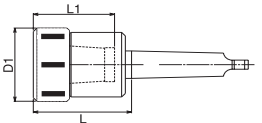

| Taper | Collet Series | Collet Range | L | L1 | D | Tightening Torque (Nm) | Code No. | Price \$ |
|-------|---------------|--------------|------|------|------|------------------------|----------|----------|
| MT3 | TG100 | 3/64-1 | 3.25 | 2.73 | 2.50 | 81.3 | 534322 | 277.19 |
| MT4 | TG100 | 3/64-1 | 3.25 | 2.73 | 2.50 | 81.3 | 534324 | 291.64 |

Straight Shank TG Collet Chucks

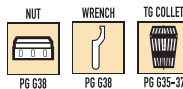
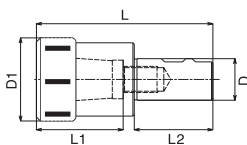

| Shank Dia. | Collet Series | Collet Range | L | L1 | L2 | D1 | Tightening Torque (Nm) | Code No. | Price \$ |
|------------|---------------|--------------|------|------|------|------|------------------------|----------|----------|
| 1-1/2 | TG100 | 3/64-1 | 9.00 | 2.73 | 6.00 | 2.50 | 81.3 | 534320 | 207.53 |

TG75 Standard & Sealed Collets



- 1/64" collapse per collet
- 0.0005" in TIR precision per DIN 6341
- 80 ft/lbs maximum tightening torque

Sealed Collets

- Sealed for coolant-through applications
- Pressure resistance tested to 1000 psi
- Sealed with rubber



| Size (in.) | Regular Code No. | Price \$ | Sealed Code No. | Price \$ |
|------------|------------------|----------|-----------------|----------|
| 3/64 | 334790 | 38.48 | - | - |
| 1/16 | 334791 | 38.48 | - | - |
| 5/64 | 334792 | 38.48 | - | - |
| 3/32 | 334800 | 38.48 | - | - |
| 7/64 | 334801 | 38.48 | - | - |
| 1/8 | 334802 | 37.35 | 334843 | 74.62 |
| 9/64 | 334803 | 38.48 | 334844 | 74.62 |
| 5/32 | 334804 | 38.48 | 334845 | 74.62 |
| 11/64 | 334805 | 37.35 | 334846 | 74.62 |
| 3/16 | 334806 | 38.48 | 334847 | 74.62 |
| 13/64 | 334807 | 37.35 | 334848 | 74.62 |
| 7/32 | 334808 | 38.48 | 334849 | 74.62 |
| 15/64 | 334809 | 37.35 | 334850 | 74.62 |
| 1/4 | 334810 | 37.35 | 334851 | 74.62 |
| 17/64 | 334811 | 37.35 | 334852 | 74.62 |
| 9/32 | 334812 | 38.48 | 334853 | 74.62 |
| 19/64 | 334813 | 37.35 | 334854 | 74.62 |
| 5/16 | 334814 | 38.48 | 334855 | 74.62 |
| 21/64 | 334815 | 37.35 | 334856 | 74.62 |
| 11/32 | 334816 | 37.35 | 334857 | 74.62 |
| 23/64 | 334817 | 38.48 | 334858 | 74.62 |
| 3/8 | 334818 | 38.48 | 334859 | 74.62 |
| 25/64 | 334819 | 38.48 | 334860 | 74.62 |
| 13/32 | 334820 | 37.35 | 334861 | 74.62 |
| 27/64 | 334821 | 38.48 | 334862 | 74.62 |
| 7/16 | 334822 | 38.48 | 334863 | 74.62 |
| 29/64 | 334823 | 38.48 | 334864 | 74.62 |
| 15/32 | 334824 | 37.35 | 334865 | 74.62 |
| 31/64 | 334825 | 38.48 | 334866 | 74.62 |
| 1/2 | 334826 | 37.35 | 334867 | 74.62 |
| 33/64 | 334827 | 38.48 | 334868 | 74.62 |
| 17/32 | 334828 | 37.35 | 334869 | 74.62 |
| 35/64 | 334829 | 38.48 | 334870 | 74.62 |
| 9/16 | 334830 | 38.48 | 334871 | 74.62 |
| 37/64 | 334831 | 38.48 | 334872 | 74.62 |
| 19/32 | 334832 | 37.35 | 334873 | 74.62 |
| 39/64 | 334833 | 38.48 | 334874 | 74.62 |
| 5/8 | 334834 | 38.48 | 334875 | 74.62 |
| 41/64 | 334835 | 38.48 | 334876 | 74.62 |
| 21/32 | 334836 | 37.35 | 334877 | 74.62 |
| 43/64 | 334837 | 38.48 | 334878 | 74.62 |
| 11/16 | 334838 | 37.35 | 334879 | 74.62 |
| 45/64 | 334839 | 38.48 | 334880 | 74.62 |
| 23/32 | 334840 | 38.48 | 334881 | 74.62 |
| 47/64 | 334841 | 38.48 | 334882 | 74.62 |
| 3/4 | 334842 | 38.48 | 334883 | 74.62 |

• See page G38 for Dimensional Data