

Replacement TG Chuck Nuts



Description	Tightening Torque (Nm)	Code No.	Price \$
*TG75 Nut	81.3	534760	109.68
*TG100 Nut	81.3	534762	72.19
*TG150 Nut	94.9	534764	113.06
TG75 Nut, Solid	81.3	534830	109.68
TG100 Nut, Solid	81.3	534832	72.19

* Photo Shown / This style is supplied with chuck

TG Chuck Wrenches



Description	Code No.	Price \$
Fits TG75 Chuck	534772	66.65
Fits TG100 Chuck	534774	40.26
Fits TG150 Chuck	534776	71.11

Replacement TG Backup Screws



Description	Code No.	Price \$
TG75	534778	12.18
TG100	534782	11.72
TG150	534786	13.85
TG150 Coolant	534788	15.84

TG Collet Dimensional Data

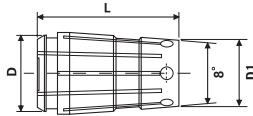

Style	D	D1	L	Collet Range
TG25	0.425	0.325	0.709	3/64-1/4
TG50	0.760	0.594	1.437	1/8-1/2
TG75	1.063	0.871	1.844	3/64-3/4
TG100	1.278	1.121	2.386	3/64-1
TG150	1.875	1.678	3.000	1/2-1-1/2

CAT40 Milling Chucks

- DIN coolant through the flange at no extra charge
- Rough milling or 'hogging' operations
- Improved tool life over regular end mill holders
- '360°' gripping contact
- Extreme rigidity over taper collets
- TIR, 0.0002"
- AT2 Taper Accuracy
- RFID chip hole

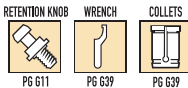
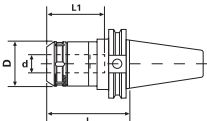

Taper	Collet Series	Collet Range	d	L	L1	D	Tightening Torque (Nm)	Code No.	Price \$
CT40	GS 3/4	0.125-0.750	0.750	3.54	3.15	2.05	50-70	531253	717.12
CT40	GS 3/4	0.125-0.750	0.750	4.14	3.15	2.05	50-70	531250	717.12
CT40	GS 1	0.125-1.00	1.00	3.54	3.15	2.41	50-70	531255‡	717.12
CT40	GS 1	0.125-1.00	1.00	4.14	3.15	2.41	50-70	531254	717.12
CT40	GS 1-1/4	0.187-1.25	1.25	3.54	3.34	2.88	60-80	531257‡	717.12
CT40	GS 1-1/4	0.187-1.25	1.25	4.14	3.34	2.88	60-80	531256	717.12
CT40	GS 1-1/4	0.187-1.25	1.25	5.32	4.73	2.88	60-80	531258	741.38

‡ Not DIN Coolant

CAT40 DUAL CONTACT Milling Chucks

- Improves rigidity and reduces vibration allowing for increased feed rates and increased tool life
- DIN coolant through the flange at no extra charge
- Rough milling or 'hogging' operations
- '360°' gripping contact
- Improved tool life over regular end mill holders
- Extreme rigidity over taper collets
- TIR, 0.0002"
- RFID chip hole
- AT2 Taper Accuracy

FOR DUAL CONTACT SPINDLES

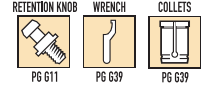
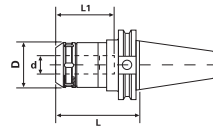

Taper	Collet Series	Collet Range	d	L	L1	D	Tightening Torque (Nm)	Code No.	Price \$
CT40	GS 3/4	0.125-0.750	0.750	3.54	3.15	2.05	50-70	521253	634.17
CT40	GS 1	0.125-1.00	1.00	3.54	3.15	2.41	50-70	521255‡	634.17
CT40	GS 1-1/4	0.187-1.25	1.25	3.54	3.34	2.88	60-80	521257‡	634.17

‡ Not DIN Coolant

BT Taper Milling Chucks

- TIR 0.0004"
- AT2 Taper Accuracy
- RFID chip hole

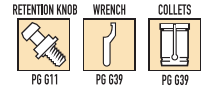
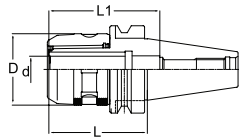

Taper	Collet Series	Collet Range	d	L	L1	D	Code No.	Price \$
BT30								
BT30	GS 3/4	0.125-0.750	0.750	3.55	3.15	2.05	532096‡	717.12
BT40								
BT40	GS 3/4	0.125-0.750	0.750	4.14	3.15	2.05	532098	717.12
BT40	GS 3/4	0.125-0.750	0.750	4.73	3.15	2.05	532100	717.12
BT40	GS 1	0.125-1.00	1.00	4.14	3.15	2.41	532102	717.12
BT40	GS 1-1/4	0.187-1.25	1.25	4.14	3.34	2.88	532104	717.12
BT50								
BT50	GS 1-1/4	0.187-1.25	1.25	4.20	3.34	2.88	532113	922.01

‡ Not DIN Coolant

CAT50 Milling Chucks

- DIN coolant through the flange at no extra charge
- Rough milling or 'hogging' operations
- Improved tool life over regular end mill holders
- '360°' gripping contact
- Extreme rigidity over taper collets
- TIR, 0.0002"
- AT2 Taper Accuracy
- RFID chip hole

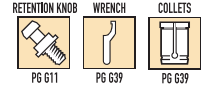
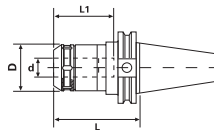

Taper	Collet Series	Collet Range	d	L	L1	D	Tightening Torque (Nm)	Code No.	Price \$
CT50	GS 3/4	0.125-0.750	0.750	4.14	3.15	2.05	50-70	531260	922.01
CT50	GS 3/4	0.125-0.750	0.750	5.32	3.15	2.05	50-70	531262	936.84
CT50	GS 3/4	0.125-0.750	0.750	6.49	3.15	2.05	50-70	531263	936.84
CT50	GS 1	0.125-1.00	1.00	4.14	3.15	2.41	50-70	531264	922.01
CT50	GS 1-1/4	0.187-1.25	1.25	3.54	4.73	2.88	60-80	531265	922.01
CT50	GS 1-1/4	0.187-1.25	1.25	4.14	4.73	2.88	60-80	531266	922.01
CT50	GS 1-1/4	0.187-1.25	1.25	5.32	4.73	2.88	60-80	531268	936.84
CT50	GS 1-1/4	0.187-1.25	1.25	6.49	4.73	2.88	60-80	531269	936.84