

CAT50 DA Collet Chucks

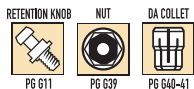

- DIN coolant through the flange
- All ground body
- TIR 0.0010"
- AT2 Taper Accuracy
- RFID chip hole

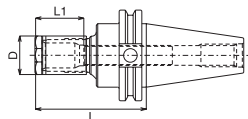

PREMIUM BALANCE
G6.3 at 25,000rpm
CERTIFICATE INCLUDED

Taper	Collet Series	Collet Range	L	L1	D	Nut Tightening Torque (ft. lbs.)	Code No.	Price \$
CT50	DA180	3/64-3/4	4.00	1.50	1.44	40	531278	314.78
CT50	DA180	3/64-3/4	6.00	1.50	1.44	40	531280	314.78

BT30 DA Collet Chucks



- All ground body
- TIR 0.0010"
- AT2 Taper Accuracy
- RFID chip hole

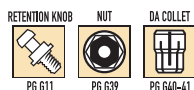
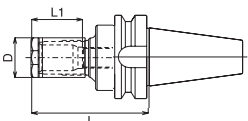

PREMIUM BALANCE
G6.3 at 30,000rpm
CERTIFICATE INCLUDED

Taper	Collet Series	Collet Range	L	L1	D	Nut Tightening Torque (ft. lbs.)	Code No.	Price \$
BT30	DA100	3/64-9/16	3.00	1.15	1.06	35	532108	219.58
BT30	DA180	3/64-3/4	3.00	1.51	1.44	40	532110	219.58
BT30	DA200	3/64-3/8	3.00	1.03	0.86	30	532112	219.58
BT30	DA300	3/64-1/4	3.00	1.04	0.55	25	532125	221.99

BT40 DA Collet Chucks



- DIN coolant through the flange
- All ground body
- TIR 0.0010"
- AT2 Taper Accuracy
- RFID chip hole

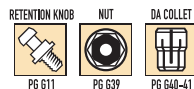
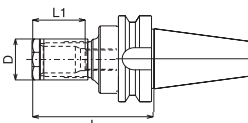

PREMIUM BALANCE
G6.3 at 30,000rpm
CERTIFICATE INCLUDED

Taper	Collet Series	Collet Range	L	L1	D	Nut Tightening Torque (ft. lbs.)	Code No.	Price \$
BT40	DA100	3/64-9/16	6.00	1.15	1.06	35	532118	273.19
BT40	DA180	3/64-3/4	4.00	1.51	1.44	40	532120	253.93
BT40	DA180	3/64-3/4	6.00	1.51	1.44	40	532122	273.19
BT40	DA200	3/64-3/8	3.00	1.03	0.86	30	532124	253.93

DA Collet Chuck Extensions

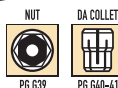
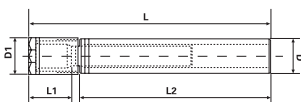
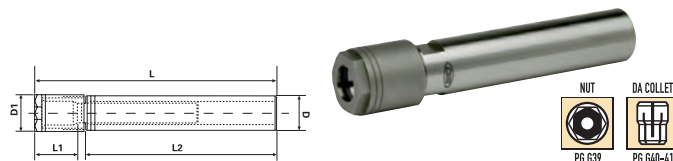

Collet Series	Collet Range	Shank Dia. (D)	O.A.L. L	L1	L2	D1	Code No.	Price \$
DA100	3/64-9/16	1	5.00	1.66	3.00	1.06	534220	221.91
DA100	3/64-9/16	1	7.50	1.66	5.50	1.06	534222	243.73
DA180	3/64-3/4	1-1/4	5.00	1.83	3.00	1.44	534224	218.64
DA180	3/64-3/4	1-1/4	7.50	1.83	5.50	1.44	534226	243.73
DA200	3/64-3/8	3/4	4.50	1.34	3.00	0.86	534228	223.93
DA200	3/64-3/8	3/4	7.00	1.34	5.50	0.86	534230	243.73
DA300	3/64-1/4	1/2	6.80	1.30	5.50	0.51	534232	172.27

Backup Screws For DA Collet Chucks



Description	Code No.	Price \$
DA180 Replacement Backup Screws	534288	24.93

DA100 Collets



- Collapse - 1/32"
- 0.001" TIR collet accuracy
- Made from 4140 alloy steel for improved strength, hardness, wear resistance, and corrosion resistance
- For most drilling, reaming and tapping applications



Fractional Inch	Decimal (in.)	Code No.	Price \$
3/64	0.047	331323	20.37
1/16	0.062	331325	20.37
5/64	0.078	331327	20.37
3/32	0.094	331329	20.37
7/64	0.109	331333	20.37
1/8	0.125	331335	20.37
9/64	0.141	331337	20.37
5/32	0.156	331339	20.37
11/64	0.172	331341	20.37
3/16	0.188	331343	20.37
13/64	0.203	331345	20.37
7/32	0.219	331347	20.37
15/64	0.234	331349	20.37
1/4	0.250	331351	20.37
17/64	0.266	331353	20.37
9/32	0.281	331355	20.37
19/64	0.297	331357	20.37
5/16	0.312	331359	20.37
21/64	0.328	331503	20.37
11/32	0.344	331505	20.37
23/64	0.359	331507	20.37
3/8	0.375	331322	20.37
25/64	0.391	331509	20.37
13/32	0.406	331324	20.37
27/64	0.422	331511	20.37
7/16	0.438	331326	20.37
29/64	0.453	331513	20.37
15/32	0.469	331328	20.37
31/64	0.484	331515	20.37
1/2	0.500	331330	20.37
33/64	0.516	331517	20.37
17/32	0.531	331332	20.37
35/64	0.547	331519	20.37
9/16	0.562	331521	20.37

DA100 Collet Sets



Collet	Pieces	Range	Code No.	Price \$
DA100	8pc	1/8-9/16 x 16ths	331356	162.98
DA100	11pc	1/4-9/16 x 32nds	331358	224.10
DA100	15pc	1/8-9/16 x 32nds	331362	305.59
DA100	17pc	1/16-9/16 x 32nds	331384	346.33
DA100	21pc	1/4-9/16 x 64ths	331385	427.82
DA100	29pc	1/8-9/16 x 64ths	331386	590.80
DA100	33pc	1/16-9/16 x 64ths	331387	672.29