

5C Collets

- Made of tool steel, hardened and ground to maintain original accuracy

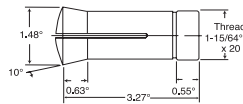

Size (in.)	GS Code No.	Price \$	STM Code No.	Price \$
1/8	325317	31.89	325315	16.64
3/16	325322	31.89	325320	16.64
1/4	325327	31.89	325325	16.64
5/16	325332	31.89	325330	16.64
3/8	325337	31.89	325335	16.64
7/16	325342	31.89	325340	16.64
1/2	325347	31.89	325345	16.64
9/16	325354	31.89	325350	16.64
5/8	325357	31.89	325355	16.64
11/16	325362	31.89	325360	16.64
3/4	325367	31.89	325365	16.64
13/16	325372	31.89	325370	16.64
7/8	325377	31.89	325375	16.64
15/16	325382	31.89	325380	16.64
1	325387	31.89	325385	16.64
5C Collet Set 1/8-1"			325310	239.70

Emergency Type Collet

- Nylon
- Can be bored to custom internal diameters to hold unusual sized workpieces

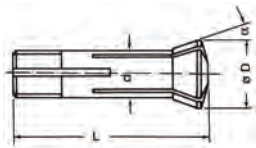

Model	Length (mm)	D (mm)	d (mm)	Head Angle α	Code No.	Price \$
VE-5CN	87	37.5	31.75	10°	325312	71.42

R8 Collets & Set

Manufactured of hardened and ground tool steel, these collets can be recommended for their accuracy and fine finish.



Size (in.)	GS Code No.	Price \$	STM Code No.	Price \$
1/8	325167	31.89	325165	12.35
5/32	325172	31.89	325170	14.76
3/16	325177	31.89	325175	14.76
7/32	325182	31.89	325180	14.76
1/4	325187	31.89	325185	14.76
9/32	325192	31.89	325190	14.76
5/16	325197	31.89	325195	14.76
11/32	325202	31.89	325200	14.76
3/8	325207	31.89	325205	14.76
13/32	325212	31.89	325210	14.76
7/16	325217	31.89	325215	14.76
15/32	325222	31.89	325220	14.76
1/2	325227	31.89	325225	14.76
9/16	325232	31.89	325230	14.76
19/32	325237	31.89	325235	14.76
5/8	325242	31.89	325240	14.76
21/32	325247	31.89	325245	14.76
11/16	325252	31.89	325250	14.76
23/32	325257	31.89	325255	14.76
3/4	325262	31.89	325260	14.76
R8 Collet Set 1/8-3/4			325300	281.09

BALANCEABLE SHRINK FIT TOOLING



Requires a balancing machine

Features and Benefits

- With threaded holes on holders over 6mm I.D. in order to balance.
- Improved concentricity.
- Improved balance design with no moving pieces.
- Low Centrifugal Forces due to low holder mass.
- Maximum gripping power with exceptional concentricity.
- Concentricity 0.0001"/0.003mm
- Chip load distributed evenly along cutting edge of tool which results in longer tool life.
- Constructed of H13 Tool Steel for exceptional durability and cycle life. With proper use, toolholder life should exceed that of standard end mill holders.
- Tool is gripped 360° along the entire length of bore resulting in an evenly distributed clamping force.
- Short projections are possible because no mechanical clamping devices are used. This results in greater rigidity and resistance to bending.
- Simple and fast to use. The total time elapsed to remove one cutting tool and insert another is less than 10 seconds.
- Through-spindle coolant capability.
- Coolant through holders require no special backup screws or seals. The fit between the I.D. of the tool holder and cutting tool shank forms the seal, preventing the coolant from flowing anywhere else except through the coolant ports. Coolant ports can be closed with a 3mm set screw. The use of Heat Shrink Tooling allows for greater speeds and feeds, better finishes, increased tool life, and increased productivity due to its High Speed Machining capability and simplicity of use.
- Note: No coolant ports or threaded balance holes on holders under 6mm I.D.

WITH 4 COOLANT PORTS

