

BT40 End Mill Holders

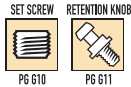

- DIN coolant option - standard
- All ground body, bore, nose, flange
- TIR, 0.0001" / 0.003mm OD to ID
- AT2 Taper Accuracy
- Certified Steel
- RFID chip hole

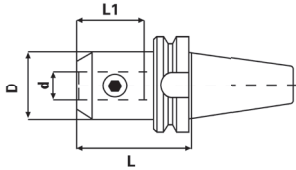

PREMIUM BALANCE
G6.3 at 30,000rpm
CERTIFICATE INCLUDED

Taper	Hole Dia. (d)	Gauge Length (L)	L1	D	Set Screw	Code No.	Price \$
BT40	1/8	1.38*	0.59	1.75	8-32	531019	147.17
BT40	1/8	2.50	0.59	0.75	8-32	531021	177.72
BT40	1/8	4.00	0.59	0.75	8-32	531023	224.92
BT40	3/16	1.38*	0.79	0.75	10-32	531025	147.17
BT40	3/16	2.50	0.79	0.75	10-32	531027	177.72
BT40	3/16	4.00	0.79	0.75	10-32	531029	224.92
BT40	1/4	1.38*	1.18	0.79	1/4-28	532018	177.72
BT40	1/4	2.50	1.18	0.79	1/4-28	532020	177.72
BT40	1/4	4.00	1.18	0.79	1/4-28	532022	224.92
BT40	5/16	1.38*	1.18	0.87	5/16-24	532024	177.72
BT40	5/16	2.50	1.18	0.87	5/16-24	532026	177.72
BT40	5/16	4.00	1.18	0.87	5/16-24	532028	224.92
BT40	3/8	1.38*	1.57	1.00	3/8-24	532030	177.72
BT40	3/8	2.50	1.57	1.00	3/8-24	532032	177.72
BT40	3/8	4.00	1.57	1.00	3/8-24	532034	224.92
BT40	7/16	2.50	1.50	1.38	7/16-20	532036	177.72
BT40	1/2	1.75*	1.50	1.38	7/16-20	532038	177.72
BT40	1/2	2.50	2.56	1.38	7/16-20	532040	177.72
BT40	1/2	4.00	2.56	1.38	7/16-20	532042	224.92
BT40	5/8	1.75*	1.97	1.65	9/16-18	532044	177.72
BT40	5/8	2.50	2.76	1.65	9/16-18	532046	177.72
BT40	5/8	4.00	3.50	1.65	9/16-18	532048	224.92
BT40	3/4	1.75*	2.01	1.89	5/8-18	532050	177.72
BT40	3/4	2.50	2.56	1.89	5/8-18	532052	177.72
BT40	3/4	4.00	2.56	1.89	5/8-18	532054	224.92
BT40	7/8	3.38	4.06	2.00	5/8-18	532056	230.47
BT40	7/8	6.00	2.08	2.00	5/8-18	532058	238.81
BT40	1	2.00*	2.32	2.25	3/4-16	532060	230.47
BT40	1	3.56	3.54	2.36	3/4-16	532062	230.47
BT40	1	6.00	3.54	2.36	3/4-16	532064	238.81
BT40	1-1/4	2.00*	2.36	2.25	3/4-16	532066‡	238.81
BT40	1-1/4	3.56	3.54	2.48	3/4-16	532068	238.81
BT40	1-1/4	6.00	3.54	2.48	3/4-16	532070	291.56
BT40	1-1/2	4.50	3.15	2.99	3/4-16	532072	238.81
BT40	1-1/2	6.00	3.15	2.99	3/4-16	532074	291.56

* Stubby Length

‡ Not DIN Coolant

BT40 DIRECT COOLANT End Mill Holders



NOW 3 COOLANT OPTIONS ALL IN ONE!

- Coolant through the spindle
- DIN coolant through flange option
- Coolant through the body
- All ground body, bore, nose, flange
- TIR, 0.0001" / 0.003mm OD to ID
- AT2 Taper Accuracy
- Certified Steel
- RFID chip hole



DIRECT COOLANT

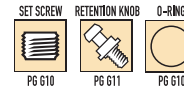
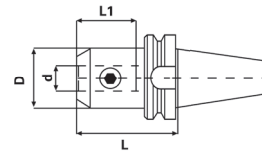

PREMIUM BALANCE
G6.3 at 30,000rpm
CERTIFICATE INCLUDED

Taper	Hole Dia. (d)	Gauge Length (L)	L1	D	Set Screw	Code No.	Price \$
BT40	1/4	4.00	1.10	0.79	1/4-28	522246	254.26
BT40	3/8	2.50	1.57	1.00	3/8-24	522256	252.16
BT40	3/8	4.00	1.57	1.00	3/8-24	522258	254.26
BT40	1/2	2.50	2.56	1.38	7/16-20	522264	254.26
BT40	1/2	4.00	2.56	1.38	7/16-20	522266	254.26
BT40	3/4	2.50	2.56	1.89	5/8-18	522276	254.26
BT40	3/4	4.00	2.56	1.89	5/8-18	522278	254.26
BT40	1	2.00*	2.32	2.25	3/4-16	522282	252.16

BT50 End Mill Holders



- DIN coolant option - standard
- All ground body, bore, nose, flange
- TIR, 0.0001" / 0.003mm OD to ID
- AT2 Taper Accuracy
- Certified Steel
- RFID chip hole

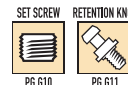
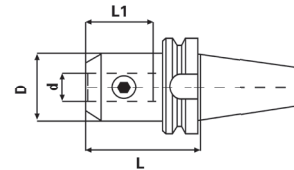

PREMIUM BALANCE
G6.3 at 25,000rpm
CERTIFICATE INCLUDED

Taper	Hole Dia. (d)	Gauge Length (L)	L1	D	Set Screw	Code No.	Price \$
BT50	3/8	2.50	1.57	1.00	3/8-24	532075	408.19
BT50	3/8	5.31	1.57	1.00	3/8-24	532076	590.07
BT50	1/2	2.75	1.77	1.38	7/16-20	532077	408.19
BT50	1/2	5.31	1.77	1.38	7/16-20	532078	590.07
BT50	5/8	3.00	1.77	1.65	9/16-18	532079	408.19
BT50	5/8	5.31	1.77	1.65	9/16-18	532081	590.07
BT50	3/4	3.00	2.76	1.75	5/8-18	532083	408.19
BT50	3/4	6.00	3.82	1.75	5/8-18	532085	590.07
BT50	1	4.00	4.21	2.36	3/4-16	532087	408.19
BT50	1	6.00	3.54	2.36	3/4-16	532089	617.85
BT50	1-1/4	4.00	3.54	2.48	3/4-16	532091	408.19
BT50	1-1/4	6.00	3.54	2.48	3/4-16	532093	631.72
BT50	1-1/2	4.13	3.15	2.99	3/4-16	532095	645.60
BT50	1-1/2	7.00	3.15	2.99	3/4-16	532097	728.91
BT50	2	4.72	4.13	3.86	1-14	532099	645.60