

Dead Centres Type 665

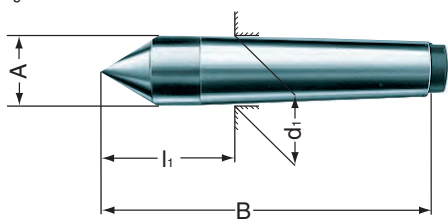

- Full point
- Completely hardened and ground
- Material: tool steel



Morse Taper	Rohm Id No.	A (mm)	B (mm)	d1 (mm)	l1 (mm)	Code No.	Price \$
0	013706	9.2	70	9.045	20	394045	71.82
1	013707	12.2	80	12.065	26.5	394050	50.89
2	013709	18	100	17.780	36	394055	71.82
3	013711	24.1	125	23.825	44	394060	95.77
4	013712	31.6	160	31.267	57.5	394065	130.34
5	013715	44.7	200	44.399	70.5	394070	239.40
6	013718	63.8	270	63.348	88	394075	597.17

Dead Centres Type 670



- Half point, carbide tipped
- Completely hardened and ground

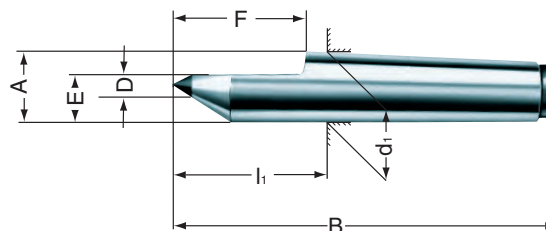

M.T.	Rohm Id No.	A (mm)	B (mm)	D (mm)	E (mm)	F (mm)	d1 (mm)	l1 (mm)	Code No.	Price \$
2	027439	18	100	7	11	30	17.780	36	394210	266.00
3	027440	24.1	125	11	15	38	23.825	44	394215	353.77
4	026571	31.6	160	14	21	50	31.267	57.5	394220	500.07
5	027441	44.7	200	18	29.4	63	44.399	70.5	394225	899.08

Dead Centres Type 667



- Full point, carbide tipped
- Completely hardened and ground

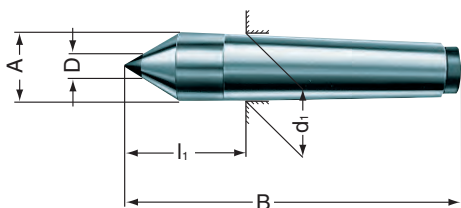

Morse Taper	Rohm Id No.	A (mm)	B (mm)	D (mm)	d1 (mm)	l1 (mm)	Code No.	Price \$
3	017172	24.1	125	11	23.825	44	394130	239.40
4	017173	31.6	160	14	31.267	57.5	394135	331.17
5	017174	44.7	200	18	44.399	70.5	394140	597.17

Dead Centres Type 671



- Full point with draw-off nut
- Completely hardened and ground

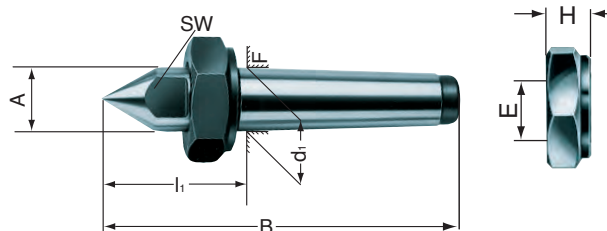

M.T.	Rohm Id No.	A (mm)	B (mm)	SW (mm)	E (mm)	F (mm)	d1 (mm)	l1 (mm)	Code No.	Price \$
3	005654	24.1	138	19	M27 x 1.5	41	23.825	57	394240	146.31
4	005357	31.6	175	27	M36 x 1.5	55	31.267	72.5	394245	198.17
5	005381	44.7	217	36	M48 x 1.5	75	44.399	87.5	394250	372.40
6	005426	63.8	290	55	M68 x 1.5	100	63.348	108	394255	989.53

Dead Centres Type 677



- Full point, carbide tipped
- Completely hardened and ground

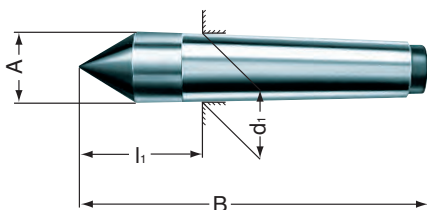

Morse Taper	Rohm Id No.	A (mm)	B (mm)	d1 (mm)	l1 (mm)	Code No.	Price \$
2	326786	18	100	17.780	36	394150	353.77
3	306402	24.1	125	23.825	44	394155	473.48
4	221398	31.6	160	31.267	57.5	394160	668.99
5	326816	44.7	200	44.399	70.5	394165	1,193.00

Dead Centres Type 672



- Extended full point with draw-off nut
- Completely hardened and ground

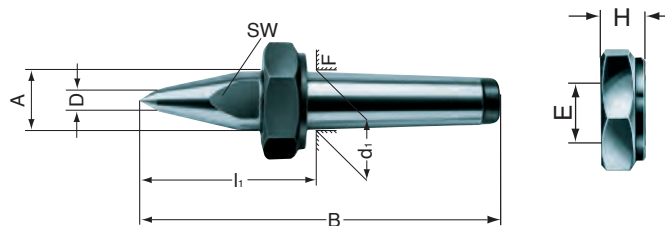

M.T.	Rohm Id No.	A (mm)	B (mm)	SW (mm)	D (mm)	E (mm)	Nut Dia. (mm)	d1 (mm)	l1 (mm)	Code No.	Price \$
3	249576	24.1	148	19	10	M27 x 1.5	41	23.825	67	394265	156.95
4	249577	31.6	186.5	27	14	M36 x 1.5	55	31.267	84	394270	206.15
5	249578	44.7	242	36	16	M48 x 1.5	75	44.399	112	394275	391.02
6	249579	63.8	330	55	20	M68 x 1.5	100	63.348	148	394280	1,050.71