

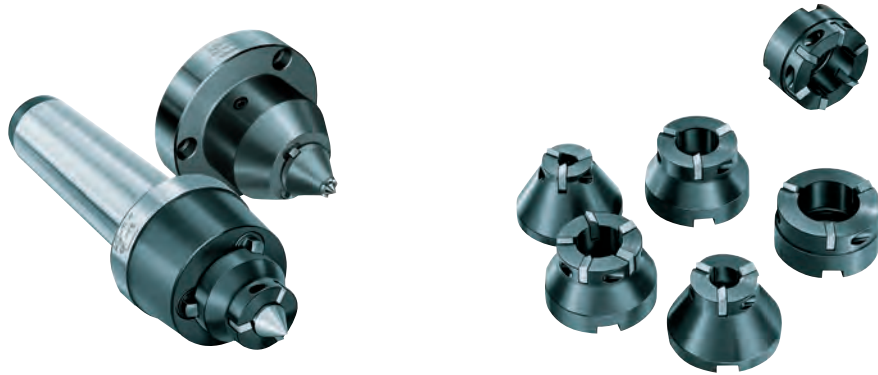

CONSTANT FACE DRIVERS



CONSTANT FACE DRIVERS

For rational turning of workpieces on their entire length without reclamping with high precision.

Developed according to the modular-design principle, therefore a universal exchange of driving discs and centres.

Hydraulic respectively mechanic pressure compensation provides a uniform clamping force also on uneven faces of workpieces. The spring loaded centre provides a longitudinal workpiece stop on the front side.

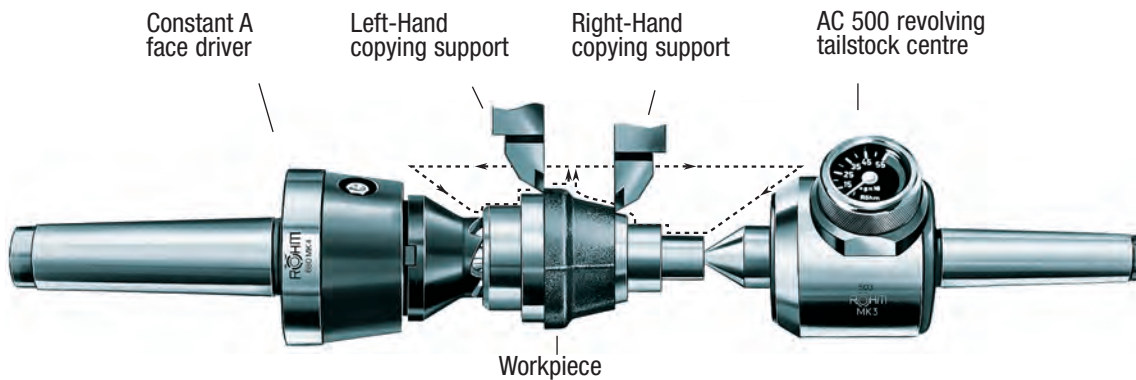

CONSTANT FACE DRIVERS CoA

One set consists of a basic body, one driving disc and suitable centre

Basic Body CoA — Type 680-50

- Basic body with morse taper (all basic bodies without centre)



Morse Taper	Rohm Id No.	Code No.	Price \$
3	088173	394390	923.46
4	088174	394395	962.65
5	088175	394400	1,796.05
6	088176	394405	1,334.06

Basic Body CoA — Type 681-85

- Basic body with short taper DIN 55026 mechanical compensation, with spring set



Short Taper	Rohm Id No.	Code No.	Price \$
6	313906	394425	3,194.62
8	313907	394420	3,773.90

Basic Body CoA — Type 680-65

- Basic body for clamping in lathe chuck, with spring set



Shank	Rohm Id No.	Code No.	Price \$
25mm	088074	394410	1,451.63

Basic Body CoA — Type 680-60

- Basic body flange type with cylindrical centre mount diameter 100mm with spring set



Flange Mount	Rohm Id No.	Code No.	Price \$
ZD 100	088046	394415	2,044.56