

## Adjustable Swivel Angle Plate

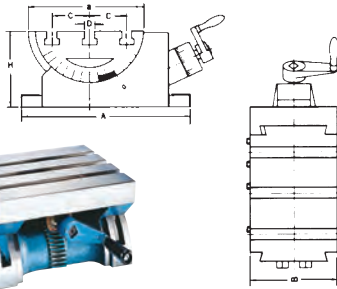

### Special Features:

- The CL Adjustable Swivel Angle Plate is mainly used for precise angle finishing, suitable for wide purposes
- CL-1 is Bolt Lock Style



Model No.	A	a	B	C	D	H	T-Slots	Weight Capacity	Code No.	Price \$
CL-1	252	180	125	55	14	115	3	20 kg	326126	1,884.69
CL-2	300	240	180	65	16	150	3	30 kg	326128	1,769.18

## Angle Plate



### BRA-180 BRA-250 BRA-380

- Low profile
- Micro reading 5 min
- Adjustable 45° each side
- Special design for angle setting on various machine tools

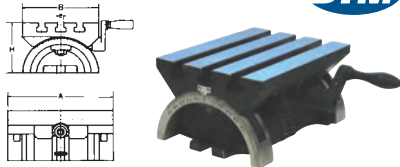

Model No.	B	A	H	T-Slot E	Weight (kg)	Code No.	Price \$
BRA-180	130	180	91	10	7.5 kg	326120	921.51
BRA-250	178	250	133	12	22.5 kg	326122	1,537.80
BRA-380	260	380	185	16	69 kg	326124	2,669.74

## Precision Steel Angle Plates



### VRS Precision Steel Angle Plates

- Material: YK30 Alloy Steel
- Hardness: 58HRC
- Accuracy: 0.005/100mm

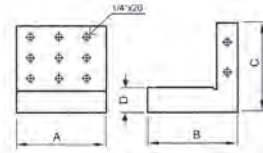

Model No.	A	B	C	D	Net Wt.	Code No.	Price \$
VRS-33	75	75	100	25	2.2 kg	370400	615.45
VRS-44	100	100	100	25	3.7 kg	370402	670.05
VRS-46	100	100	150	25	4.5 kg	370404	771.67
VRS-85	200	120	200	40	14.3 kg	370406	2,087.99
VRS-1206	300	150	300	50	32.3 kg	370408	3,091.04

## Suburban Precision Ground Angle Plates



- Solid one piece angle plates are made from hardened steel
- Square and parallel within 0.0002"
- Tapped holes



Model No.	Dimensions (in.)	Weight (lb)	Code No.	Price \$
AP-334	3 x 3 x 4 x 1	6 lb	251260	514.75
AP-444-S1	4 x 4 x 4 x 1	10 lb	251264	784.45
AP-446-S2	4 x 4 x 6 x 1	14 lb	251276	962.80
AP-664-S1	6 x 6 x 4 x 1-1/4	20 lb	251278	1,448.55

## Suburban Compound Angle Plate



Solid, single piece, hardened steel construction provides stable and reliable positioning for compound use. Comes with one clamp and all holes are tapped. Plate is square and parallel within 0.0002".



Model No.	Dimensions	Weight (lb)	Code No.	Price \$
CAP-46	6 x 4 x 4 x 1	11	251280	1,741.45

## Cross Table VCT-512

Applied in general machines such as compounding machine, drilling machine, etc., or large objects of special shape which cannot be clamped by common vises.

- Lateral moving travel on surface: 11"
- Longitude moving travel on surface: 6"



Model No.	Table (mm)	Height (mm)	Travel (mm)	Base (mm)	Dial Grad. (mm)	Net Weight (kg)	Code No.	Price \$
VCT-512	300 x 140	115	200 x 125	225 x 200	0.03	16.6	230965	1,606.69

## Sine Bar

- Effectively cancels the angle being measured to check its accuracy
- Ground flat, square and parallel within 0.0002"
- Steel hardened to 52HRC



Model No.	Length (in.)	Width (in.)	Height (in.)	Centre Distance (in.)	Parallel	Hardness	Block Dia.	Material	Net Wt.	Code No.	Price \$
YCT-S25	6-3/8	1	1-1/4	5"	0.00012	52HRC	3/4	SK2	1.0kg	230760	183.77
YCT-S50	6-3/8	2	1-1/4	5"	0.00012	52HRC	3/4	SK2	1.9kg	230765	236.24