

Suburban SineSet® V-Blocks

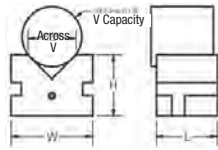

- Provides a quick, accurate and positive means of holding workpieces for layout, machining, grinding or inspection
- Solid one-piece steel construction, hardened to 58-60 HRC
- One reversible, swing-away clamp is provided with each v-block
- Side slots allow easy clamping to almost any work surface
- SineSet® models bolt directly to a SineSet® sine plate or compound sine plate of the same series. S1 models also bolt to the AP-664-S1 90° conversion plate
- Available in both 60° and 90° models and as single vee blocks or matched pairs
- M = Matched pairs

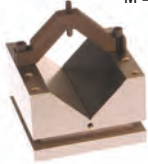

Model No.	L	W	H	Across Vee	Vee Cap.	Square Parallel & Central	Code No.	Price \$
90° Vee Blocks								
VB-222-S0	2-1/2"	2-1/2"	2"	1-15/32"	1-5/8"	0.0002"	251946	461.10
VB-222-M-S0	2-1/2"	2-1/2"	2"	1-15/32"	1-5/8"	0.0002"	251948	1,162.90
VB-334-S1	3"	4"	3"	2-7/32"	2-7/8"	0.0002"	251950	669.90
VB-334-M-S1	3"	4"	3"	2-7/32"	2-7/8"	0.0002"	251952	1,531.20
VB-466-S2	6"	6"	4"	3-31/32"	4-3/8"	0.0003"	251954	1,593.55
VB-466-M-S2	6"	6"	4"	3-31/32"	4-3/8"	0.0003"	251956	3,770.00
60° Vee Blocks								
VB-602-M-S0	2-1/2"	2-1/2"	2"	1-15/32"	1-3/8"	0.0002"	251930	2,118.45
VB-604-S1	3"	4"	3"	1-31/32"	2-1/8"	0.0002"	251932	1,162.90
VB-604-M-S1	3"	4"	3"	1-31/32"	2-1/8"	0.0002"	251934	2,740.50

Slotted Angle Plates — Webbed Style



- Made from class 35-40 cast iron
- Multiple clamping slots for easy mounting of workpieces
- Ground finish (up to 20"), square and parallel within 0.0005" per 6"

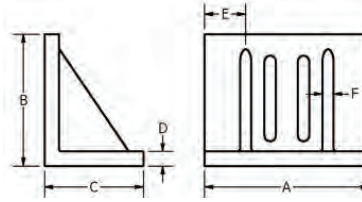

Model	A (in.)	B (in.)	C (in.)	D (in.)	E (in.)	F (in.)	No. Webs	Slots (in.)	Wt. (lb)	Code No.	Price \$
SAW-030302-G	3-1/2	3	2-1/2	9/16	1-3/4	1/2	1	(4) 7/16	4	251601	345.10
SAW-040303-G	4-1/2	3-1/2	3	9/16	2-1/4	1/2	1	(4) 9/16	5	251603	203.00
SAW-060504-G	6	5	4-1/2	11/16	3	9/16	1	(4) 11/16	13	251605	437.90
SAW-070504-G	7	5-1/2	4-1/2	11/16	3-1/2	9/16	1	(4) 11/16	14	251607	624.95
SAW-080605-G	8	6	5	3/4	2	5/8	2	(4) 9/16	22	251609	778.65
SAW-090706-G	9	7	6	3/4	2-1/4	5/8	2	(4) 11/16	28	251611	957.00
SAW-100806-G	10	8	6	7/8	2-1/2	11/16	2	(4) 11/16	37	251613	1,064.30
SAW-120908-G	12	9	8	1	3	3/4	2	(11) 11/16	63	251615	1,703.75

Giant Slotted Webbed Angle Plates



- Made of high quality fine grained cast iron, stress relieved
- Machined finish - square and parallel within 0.002" per 6"
- Extra thickness and heavy ribbed construction
- Multiple slots for many bolting and clamping possibilities

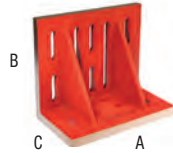

Model No.	A (in.)	B (in.)	C (in.)	Wall Thickness	Weight (lb)	Code No.	Price \$
GAW-161209	16	12	9	1-1/8	112	251630	2,834.75
GAW-201612	20	16	12	1-1/8	200	251632	4,062.90
GAW-122418	12	24	18	1-1/2	300	251634	5,272.20
GAW-183024	18	30	24	1-3/4	700	251636	10,239.90

Slotted Angle Plates — Open End Style



- Made from class 35-40 cast iron
- Multiple clamping slots for easy mounting of workpieces
- Ground finish (up to 20"), square and parallel within 0.0005" per 6"

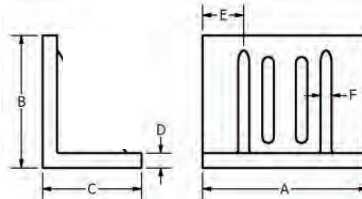

Model	A (in.)	B (in.)	C (in.)	D (in.)	Slots (in.)	Weight (lb)	Code No.	Price \$
SAO-040303-G	4-1/2	3-1/2	3	5/8	(4) 9/16	4	251617	319.00
SAO-060504-G	6	5	4-1/2	13/16	(7) 9/16	12	251619	439.35
SAO-070504-G	7	5-1/2	4-1/2	13/16	(8) 9/16	14	251621	514.75
SAO-080605-G	8	6	5	15/16	(8) 9/16	20	251623	600.30
SAO-090706-G	9	7	6	15/16	(13) 11/16	24	251625	743.85
SAO-100806-G	10	8	6	1-1/16	(13) 11/16	33	251627	1,154.20
SAO-120908-G	12	9	8	1-3/16	(13) 11/16	62	251629	1,876.30

Giant T-Slotted Webbed Angle Plates



- Provides an accurate vertical base for mounting vises, sub-plates, parts or fixtures
- Standard 5/8" T-slots on a 6" grid pattern are provided on both faces
- Made from one piece, class 40 cast iron that has been stress relieved
- Extra heavy 2-1/2" wall thickness provides stability during milling operations
- Faces and edges machined flat, square and parallel within 0.001" per 12"

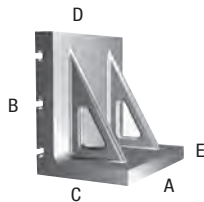

Model No.	A (in.)	B (in.)	C (in.)	D (in.)	E (in.)	Weight (lb)	Code No.	Price \$
TAP-121818	18	18	12	2-1/2	2	450	251638	8,420.15
TAP-122424	24	24	12	2-1/2	2	700	251640	9,610.60

Slotted Angle Plates — Webbed & Open



Made of high-tensile cast iron seasoned against distortion, skillfully machined square and parallel, these plates are supplied in two types, Type A and Type B, the former having side webs.

Type A-Webbed: Machined on outside surfaces and edges only.

Type B-Opened: Machined all over, except slots.

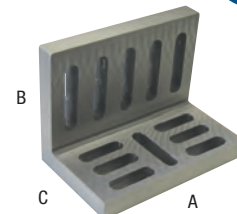

A	B	C	Webbed Code No.	Price \$	Open Code No.	Price \$
3	2-1/2	2	370306	104.49	-	-
3-1/2	3	2-1/2	370311	117.46	-	-
4-1/2	3-1/2	3	370316	133.62	370356	166.06
6	5	4-1/2	370321	211.54	370361	244.19
7	5-1/2	4-1/2	370326	257.26	370366	312.36
8	6	5	370331	330.47	370371	364.13
9	7	6	370336	411.58	370376	502.29
10	8	6	370341	507.06	370381	569.00
12	9	8	370346	778.25	370386	864.30

Magnetic Angle Iron



- A versatile tool for layout, inspection and squaring operations
- Combines the advantages of a universal right angle iron and a permanent magnetic chuck
- Magnetic face is energized by turning a recessed control knob
- Can be placed on any side for workholding
- Heavy support rib provides structural strength and acts as a carrying handle
- Body made from class 35-40 cast iron



Model No.	Length	Width	Height	Flat, Square & Parallel	Weight (lbs)	Code No.	Price \$
MAI-644	4-3/4	4-1/4	6-1/2	0.0003"	18	251370	4,496.45