

Camlock Mount Adapters For F/A Chucks

D - Type

FULLY MACHINED TYPE D STEEL ADAPTERS FOR F/A CHUCKS

- Type D1 American Standard Camlock Spindles
- Type 8245

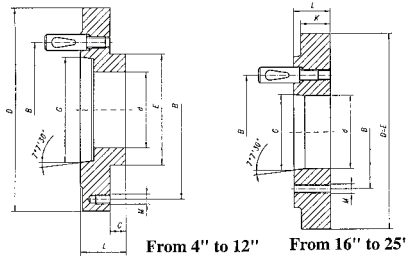

| Chuck Dia. | Taper Size | Studs Qty | Dia. | D | B | G | d | E | F | M | C | L | K | Weight lbs. | Code No. | Price \$ |
|------------|------------|-----------|--------|-------|-------|---------|-------|-------|--------|-----------|------|------|------|-------------|----------|----------|
| 4" | D1-3 | 3 | 9/16 | 3.94 | 2.78 | 2.1250 | 0.787 | 1.771 | 3.268 | M8 X 1.25 | 0.47 | 1.50 | | 3.31 | 435690 | 685.11 |
| | D1-4 | | 5/8 | 4.25 | 3.25 | 2.5005 | | | | | | 1.57 | | 3.97 | 435691 | 685.11 |
| 5" | D1-3 | 3 | 9/16 | 4.92 | 2.78 | 2.1250 | 1.378 | 2.164 | 4.252 | M8 X 1.25 | 0.55 | 1.57 | | 5.95 | 435692 | 644.30 |
| | D1-4 | 3 | 5/8 | 4.92 | 3.25 | 2.5005 | | | | | | 1.54 | | 5.73 | 435693 | 644.30 |
| | D1-5 | 6 | 3/4 | 5.31 | 4.13 | 3.2503 | | | | | | 1.73 | | 6.92 | 435694 | 644.30 |
| 6-1/4" | D1-6 | 6 | 7/8 | 7.12 | 5.25 | 4.1878 | | | | | | 1.89 | | 13.06 | 435695 | 644.30 |
| | D1-3 | 3 | 9/16 | 6.30 | 2.78 | 2.1250 | 1.654 | 3.385 | 5.512 | M10 X 1.5 | 0.63 | 1.81 | | 10.80 | 435700 | 793.92 |
| | D1-4 | 3 | 5/8 | 6.30 | 3.25 | 2.5005 | | | | | | 1.81 | | 9.92 | 435705 | 793.92 |
| 8" | D1-5 | 6 | 3/4 | 6.30 | 4.13 | 3.2503 | | | | | | 1.81 | | 9.89 | 435710 | 793.92 |
| | D1-6 | 6 | 7/8 | 6.69 | 5.25 | 4.1878 | | | | | | 1.97 | | 13.00 | 435712 | 793.92 |
| | D1-3 | 3 | 9/16 | 7.87 | 2.78 | 2.1250 | 2.024 | 4.330 | 6.929 | M10 X 1.5 | 0.67 | 1.30 | | 10.36 | 435715 | 840.55 |
| 10" | D1-4 | 3 | 5/8 | | 3.25 | 2.5005 | 2.165 | | | | | 1.30 | | 10.36 | 435720 | 840.55 |
| | D1-5 | 6 | 3/4 | | 4.13 | 3.2503 | 2.165 | | | | | 1.85 | | 15.87 | 435725 | 907.39 |
| | D1-6 | 6 | 7/8 | | 5.25 | 4.1878 | 2.165 | | | | | 2.01 | | 17.64 | 435730 | 907.39 |
| 12-1/2" | D1-6 | 6 | 7/8 | 12.40 | 5.25 | 4.1878 | 4.055 | 7.086 | 11.260 | M16 X 2 | 0.75 | 1.50 | | 28.44 | 435750 | 1,425.83 |
| | D1-8 | | 1 | | 6.75 | 5.50055 | | | | | | 2.24 | | 47.84 | 435755 | 1,425.83 |
| | D1-11 | | 1-3/16 | | 9.25 | 7.75055 | | | | | | 2.52 | | 52.91 | 435760 | 1,425.83 |
| 15-3/4" | D1-6 | 6 | 7/8 | 11.75 | 5.25 | 4.1878 | 4.055 | 11.75 | 6.718 | 5/8-11 | | 1.38 | 0.87 | 29.0 | 435762 | 1,553.40 |
| | D1-8 | | 1 | | 6.75 | 5.50055 | 5.358 | | | | | 1.50 | | 27.2 | 435764 | 1,553.40 |
| | D1-11 | | 1-3/16 | | 9.25 | 7.75055 | 5.358 | | | | | 1.89 | | 26.8 | 435766 | 1,553.40 |
| 20" | D1-8 | 6 | 1 | 16.02 | 6.75 | 5.50055 | 5.358 | 16.02 | 9.252 | 3/4-10 | | 1.50 | 1.50 | 74 | 435768 | 3,653.27 |
| | D1-11 | | 1-3/16 | | 9.25 | 7.75055 | 7.590 | | | | | 1.73 | 1.73 | 78 | 435770 | 3,653.27 |
| | D1-15 | | 1-3/8 | | 13.00 | 11.2505 | 7.480 | | | | | 2.05 | 2.05 | 83 | 435772 | 4,201.08 |
| 25" | D1-8 | 6 | 1 | 16.02 | 6.75 | 5.50055 | 5.358 | 16.02 | 13.071 | 3/4-10 | | 1.50 | 1.50 | 74 | 435774 | 4,004.88 |
| | D1-11 | | 1-3/16 | | 9.25 | 7.75055 | 7.590 | | | | | 1.73 | 1.73 | 78 | 435776 | 4,004.88 |
| | D1-15 | | 1-3/8 | | 13.00 | 11.2505 | 9.920 | | | | | 2.05 | 2.05 | 83 | 435778 | 2,848.15 |

A Taper Mount Adapters For F/A Chucks Type 8215

A - Type

STEEL ADAPTERS FOR F/A CHUCKS

- Type 8215

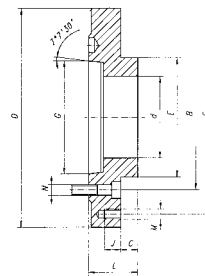

| Chuck Dia. | Taper Size | D | G | d | B | E | F | M | J | C | L | N | # of Bolts | Weight lbs. | Code No. | Price \$ |
|------------|------------|-------|---------|-------|--------|-------|--------|----------|------|------|------|---------|------------|-------------|----------|----------|
| 5" | A4 | 4.92 | 2.5005 | 1.378 | 3.252 | 2.164 | 4.252 | M8x1.25 | 0.87 | 0.55 | 1.42 | 7/16-14 | 4 | 4.8 | 435790 | 253.70 |
| | A5 | 4.92 | 3.2505 | | 4.126 | | | | 0.87 | | 1.42 | 7/16-14 | | 4.2 | 435792 | 253.70 |
| | A6 | 6.30 | 4.1880 | | 5.252 | | | | 0.53 | | 1.89 | 1/2-13 | | 9.1 | 435794 | 253.70 |
| 6-1/4" | A5 | 6.30 | 3.2505 | 1.654 | 4.126 | 3.385 | 5.512 | M10x1.5 | 0.82 | 0.62 | 1.45 | 7/16-14 | 4 | 6.77 | 435800 | 386.01 |
| 8" | A5 | 7.87 | 3.2505 | 2.165 | 4.126 | 4.330 | 6.929 | M10x1.5 | 0.62 | 0.66 | 1.29 | 3/8-16 | 4 | 9.3 | 435805 | 519.97 |
| | A6 | | 4.1880 | | 5.252 | | | | 1.10 | | 1.77 | 1/2-13 | | 13.5 | 435810 | 519.97 |
| 10" | A5 | 9.84 | 3.2505 | 2.992 | 4.126 | 5.708 | 8.819 | M12x1.75 | 0.74 | 0.74 | 1.49 | 7/16-14 | 4 | 17.3 | 435815 | 719.15 |
| | A8 | | 5.5007 | | 6.748 | | | | 1.06 | | 1.81 | 5/8-11 | | 20.2 | 435825 | 719.15 |
| 12-1/2" | A6 | 12.40 | 4.1880 | 4.055 | 5.252 | 7.086 | 11.260 | M16x2 | 0.74 | 0.74 | 1.49 | 1/2-13 | 4 | 27.3 | 435830 | 1,273.17 |
| | A8 | | 5.5007 | | 6.748 | | | | 1.06 | | 1.81 | 5/8-11 | | 35.7 | 435835 | 1,273.17 |
| | A11 | | 7.7507 | | 9.252 | | | | 1.42 | | 2.19 | 3/4-10 | | 41.20 | 435836 | 1,273.17 |
| 15-3/4" | A6 | 11.75 | 4.1880 | 4.055 | 5.252 | 11.75 | 6.748 | 5/8-11 | 1.38 | | 1.38 | 1/2-13 | 6 | 31.4 | 435837 | 1,346.45 |
| | A8 | | 5.5007 | 5.346 | 6.748 | | | | 1.14 | | 1.46 | 5/8-11 | | 28.8 | 435838 | 1,346.45 |
| | A11 | | 7.7507 | 5.354 | 9.252 | | | | 1.06 | | 1.89 | 3/4-10 | | 35.8 | 435839 | 1,346.45 |
| 20" | A8 | 16.02 | 5.5007 | 5.346 | 6.748 | 16.02 | 9.252 | 3/4-10 | 1.42 | | 1.42 | 5/8-11 | 6 | 69 | 435844 | 2,026.58 |
| | A11 | | 7.7507 | 7.590 | 9.252 | | | | 1.18 | | 1.42 | 3/4-10 | | 61 | 435846 | 2,026.58 |
| | A15 | | 11.2505 | 7.480 | 13.000 | | | | 1.18 | | 2.05 | 7/8-9 | | 76 | 435848 | 2,026.58 |
| 25" | A8 | 16.02 | 5.5007 | 5.346 | 6.748 | 16.02 | 13.000 | 3/4-10 | 1.42 | | 1.42 | 5/8-11 | 6 | 69 | 435850 | 3,359.84 |
| | A11 | 16.02 | 7.7507 | 7.590 | 9.252 | | | | 1.42 | | 1.42 | 3/4-10 | | 61 | 435852 | 3,511.52 |
| | A15 | 13.02 | 11.2505 | 9.921 | 13.000 | | | | 1.42 | | 2.05 | 7/8-9 | | 76 | 435854 | 3,511.52 |
| | A20 | 21.00 | 16.2518 | 9.921 | 18.252 | | | | 2.76 | | 2.76 | 1-8 | | 90 | 435856 | 4,775.37 |