

PRECISION LATHE CHUCKS



3-Jaw Cast Iron Scroll Chucks — Hard Solid Jaws

Features:

- 3-Jaw, self-centering scroll chuck with manual gripping and a high quality cast iron body
- Smart design, allowing inner parts to be replaced quickly
- Mounted on the machine-tool spindle from the back of the chuck, using the adapter plate

Application:

- This chuck is designed for all types of workshop machining operations on conventional lathes and milling fixtures

Replacement parts not available

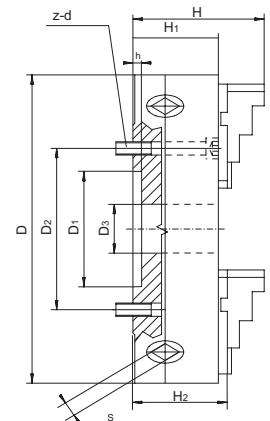
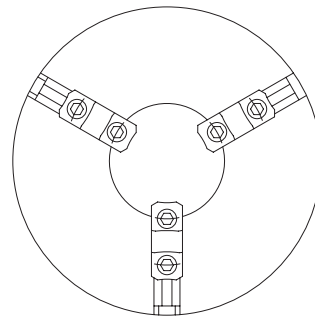

Plain Back



Chuck Size D (in.)	D1 (in.)	D2 (in.)	D3 (in.)	H (in.)	H1 (in.)	H2 (in.)	h (in.)	S (in.)	z-d	Max. Torque (ft/lbs)	Max Speed (r/min.)	Weight (lbs.)	Code No.	Price \$
3	2.165	2.598	0.630	2.598	1.969	-	0.138	0.315	3-M6	29.50	4,000	4.18	4440504	192.49
4	2.835	3.307	0.866	2.933	2.165	-	0.138	0.315	3-M6	44.26	3,500	7.04	4440505	207.96
5	3.740	4.252	1.181	3.307	2.283	-	0.157	0.394	3-M8	73.76	3,000	11.00	4440510	232.06
6	5.118	5.591	1.575	3.740	2.559	-	0.197	0.394	3-M8	118.02	2,500	19.36	4440515	331.49
8	6.496	7.087	2.559	4.291	2.953	-	0.197	0.472	3-M10	184.40	2,000	34.10	4440520	435.11
10	8.110	8.898	3.150	4.724	3.150	-	0.197	0.472	3-M12	236.03	1,600	56.54	4440525	598.31
12	10.236	11.22	3.937	5.787	3.543	-	0.236	0.551	3-M16	295.04	1,200	103.40	4440530	1,399.69