

## Metric Serrated Soft Top Jaws — Rectangular

### STM Jaws

- For Autoblok, Howa, Kitagawa, Matsumoto, Shunk

### USA Jaws

- For Kitagawa power chucks

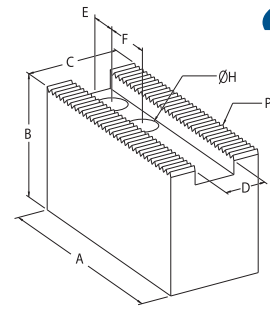

Chuck Dia.	Serration	A	B	C	D	E	F	H	Wt. (kg)	Model No.	USA Code No.	Individual Price \$	STM Italy Code No.	Individual Price \$	STM Italy Code No.	Set of 3 Price \$
110	1.5x60°	50	25	20	8	15	7	0.15	0.15	HKM.11.01/S	-	-	491215	45.94	-	-
110	1.5x60°	55	25	25	10	13	14	9	0.196	HKM.11.05/S	-	-	491220	47.47	-	-
110	1.5x60°	55	50	25	10	13	14	9	0.412	HKM.11.06/S	-	-	491225	69.62	-	-
135	1.5x60°	55	30	25	10	10	18	9	0.239	HKM.13.01/S	-	-	491235	47.82	-	-
135	1.5x60°	55	40	25	10	10	18	9	0.316	HKM.13.02/S	-	-	491240	67.85	-	-
135	1.5x60°	55	25	25	10	14	19	9	0.192	HKM.13.05/S	-	-	491250	48.07	-	-
150(6")	1.5x60°	73	38	32	12	15	20	11	-	D6SSH38	656205	46.98	-	-	-	-
150(6")	1.5x60°	73	75	32	12	15	20	11	-	D6SEH38	656252	87.47	-	-	-	-
165(6")	1.5x60°	80	30	30	12	19	20	11	0.40	HKM.16.05/S	-	-	491265	49.94	491266	156.19
165(6")	1.5x60°	75	60	30	12	19	20	11	0.76	HKM.16.08/S	-	-	491280	80.81	491281	249.36
200(8")	1.5x60°	100	50	38	14	25	25	13	-	D8SSH1	656215	72.21	-	-	-	-
210(8")	3x60°	95	40	40	14	24	25	13	0.96	HKM.21.3.01/S	-	-	491395	69.62	-	-
210(8")	1.5x60°	95	40	35	14	24	25	13	0.80	HKM.21.00/S	-	-	491295	60.79	-	-
210(8")	1.5x60°	95	40	40	14	20	25	13	0.97	HKM.21.01/AL	-	-	491305	191.07	-	-
210(8")	1.5x60°	95	40	40	14	20	25	13	0.97	HKM.21.01/S	-	-	491315	60.79	491316	178.34
210(8")	1.5x60°	95	50	40	14	20	25	13	1.20	HKM.21.02/S	-	-	491325	75.27	-	-
210(8")	1.5x60°	95	60	40	14	20	25	13	1.44	HKM.21.03/S	-	-	491335	84.81	-	-
210(8")	1.5x60°	95	80	40	14	20	25	13	1.82	HKM.21.04/S	-	-	491345	122.97	-	-
210(8")	1.5x60°	95	100	40	14	20	25	13	2.43	HKM.21.05/S	-	-	491355	143.60	-	-
210-254(8")	1.5x60°	95	40	40	16	20	25	13	0.96	HKM.21.10/S	-	-	491375	62.89	-	-
210-254(8")	1.5x60°	95	50	40	16	20	25	13	1.19	HKM.21.11/S	-	-	491380	80.81	-	-
210-254(8")	1.5x60°	95	60	40	16	20	25	13	1.40	HKM.21.12/S	-	-	491385	90.71	-	-
254(10")	1.5x60°	118	50	38	16	25	30	13	-	D10SSH	656180	73.80	-	-	-	-
254-270(10")	1.5x60°	110	40	40	16	30	30	13	1.11	HKM.25.01/AL	-	-	491405	256.79	-	-
254-270(10")	1.5x60°	110	40	40	16	30	30	13	1.11	HKM.25.01/S	-	-	491420	63.25	491421	197.54
254-270(10")	1.5x60°	110	40	40	16	-	-	-	1.11	**HKM.25.01/SB	-	-	491425	103.07	-	-
254-270(10")	1.5x60°	120	40	40	16	30	30	13	1.36	HKM.25.01/SL120	-	-	491430	68.56	-	-
254-270(10")	1.5x60°	130	40	40	16	30	30	13	1.61	HKM.25.01/SL130	-	-	491435	79.28	-	-
254-270(10")	1.5x60°	160	40	40	16	30	30	13	2.36	HKM.25.01/SL160	-	-	491437	384.47	-	-
254-270(10")	1.5x60°	110	60	40	16	30	30	13	1.70	HKM.25.02/S	-	-	491495	88.23	-	-
254-270(10")	1.5x60°	110	60	40	16	-	-	-	1.70	**HKM.25.02/SB	-	-	491450	94.00	-	-
254-270(10")	1.5x60°	110	80	40	16	30	30	13	2.28	HKM.25.03/S	-	-	491465	126.87	-	-
254-270(10")	1.5x60°	110	80	40	16	-	-	-	2.28	**HKM.25.03/SB	-	-	491470	128.98	-	-
254-270(10")	1.5x60°	110	100	40	16	30	30	13	2.90	HKM.25.04/S	-	-	491480	151.97	491481	461.85
304(12")	1.5x60°	118	50	38	18	25	30	15	-	D11SSH2	656193	103.80	-	-	-	-
304(12")	1.5x60°	140	63	50	21	19	30	17	-	D212SSH	656197	105.03	-	-	-	-
304(12")	1.5x60°	140	100	50	21	19	30	17	-	D212SEH	656242	196.21	-	-	-	-
304-381(12")	1.5x60°	130	50	50	18	25	30	15	2.05	HKM.30.01/S	-	-	491445	95.30	491496	294.01
304-381(12")	1.5x60°	130	80	50	18	25	30	15	3.44	HKM.30.03/S	-	-	491515	144.52	-	-
304-381(12")	1.5x60°	130	100	50	18	25	30	15	4.30	HKM.30.04/S	-	-	491530	160.79	491531	463.51
304(12")	1.5x60°	130	50	50	21	22	30	17	2.04	HKM.30.10/S	-	-	491545	82.21	491546	294.24
304(12")	1.5x60°	130	80	50	21	22	30	17	3.33	HKM.30.12/S	-	-	491550	143.60	491551	413.45
304(12")	1.5x60°	130	100	50	21	22	30	17	4.20	HKM.30.13/S	-	-	491560	189.18	491561	576.01
304(12")	1.5x60°	130	50	50	21	22	35	17	2.04	HKM.30.15/S	-	-	491570	95.30	-	-
381(15")	1.5x60°	159	75	63	22	25	43	21	-	D15SSH1	656198	206.28	-	-	-	-
381(15")	1.5x60°	159	100	63	22	25	43	21	-	D15SEH1	656244	283.53	-	-	-	-
381(15")	1.5x60°	159	75	63	25.5	25	43	21	-	D215SSH	656199	206.28	-	-	-	-
381(15")	1.5x60°	155	60	60	22	37	43	21	3.65	HKM.38.00/S	-	-	491585	189.18	491586	578.23
381-454(15")	1.5x60°	165	70	70	22	37	43	21	5.40	HKM.38.01/S	-	-	491605	232.51	-	-
381(15")	1.5x60°	155	100	60	22	37	43	21	6.00	HKM.38.02/S	-	-	491610	265.85	491611	771.78
381(15")	1.5x60°	155	60	60	22	30	60	21	3.65	HKM.38.04/S	-	-	491615	234.77	-	-
381(15")	1.5x60°	156	70	70	22	30	60	21	5.10	HKM.38.05/S	-	-	491630	232.51	-	-
381-454(15")	3x60°	155	60	60	22	30	50	21	3.65	HKM.38.3.00/S	-	-	491670	189.18	491671	523.12
381-454(15")	3x60°	156	70	70	22	30	50	21	5.10	HKM.38.3.01/S	-	-	491685	232.51	-	-
381(15")	3x60°	140	60	60	26	30	42	21	3.20	HKM.38.3.05/S	-	-	491695	157.60	-	-
381(15")	1.5x60°	135	60	50	25.5	26	43	21	2.49	HKM.38.10/S	-	-	491650	131.57	491651	388.95
381(15")	1.5x60°	135	100	50	25.5	26	43	21	4.14	HKM.38.12/S	-	-	491660	223.33	491661	643.75
454-610(18")	3x60°	200	70	70	25	40	60	21	6.60	HKM.53.3.01/S	-	-	491705	285.05	-	-
381-610(18")	3x60°	156	70	70	26	34	50	21	5.05	HKM.61.3.01/S	-	-	491710	255.62	-	-

\*\* Blank jaws