

Inch Serrated Soft Top Jaws — Rectangular



STM Jaws (Type I, Ia, III)

- Type I: For SMW, Berg, Gamet, Shunk, Rohm, Forkardt
- Type Ia: For self contained pneumatic power chucks
- Type III: For SMW Autoblok

USA Jaws (Type II)

- For Autoblok, Erickson, Forkardt, Gamet, Powerhold, Pratt Burnerd, Rohm and Howa (Ho12M-Self Contained Air)

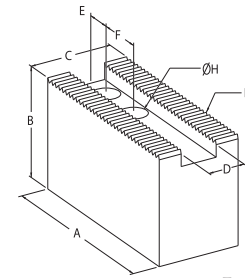

I, Ia

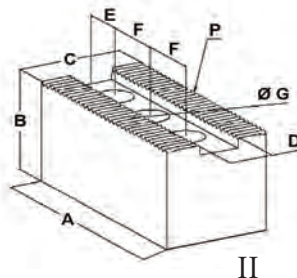

II

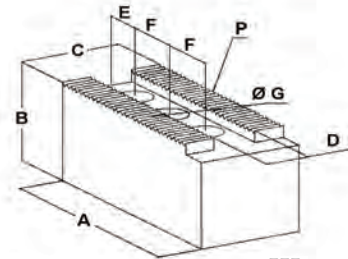

III

Chuck Dia.	Serration	Type	A	B	C	D	E	F	G	H	Wt. (kg)	Model No.	USA Code No.	Individual Price \$	STM Code No.	Individual Price \$
125	1/16x90°	I	68	40	30	11	-	18	-	M8	-	192200/S	-	-	491848	68.79
150	1/16x90°	II	75	38	29	11	11	18	-	5/16"	-	D6PSH	656300	58.99	-	-
160	1/16x90°	I	88	50	35	14	-	25	-	M10	-	192201/S	-	-	491850	80.81
160	1/16x90°	I	70	60	40	17	15	22	-	M12	1.05	242200/F	-	-	491130	73.62
200	1/16x90°	Ia	88	50	38	17	-	28	-	1/2"	-	HKM200	-	-	491800	120.53
200	1/16x90°	I	98	50	40	17	-	29	-	M12	-	192202/S	-	-	491852	85.40
200	1/16x90°	I	90	60	40	17	25	22	-	M12	1.40	242201/F	-	-	491131	75.97
200-250	1/16x90°	II	108	50	32	13	14	22	-	3/8"	-	D10PSH	656305	86.68	-	-
250	1/16x90°	I	108	70	50	21	-	30	-	M14	-	192203/S	-	-	491854	101.54
250	1/16x90°	I	120	80	50	21	30	28	-	M16	3.08	242202/F	-	-	491132	107.20
250HD	1/16x90°	II	115	50	44.5	20	16	30	-	1/2"	-	D11PSH	656310	129.45	-	-
250-315	1/16x90°	Ia	120	38	50	21	-	30	-	1/2"	-	HKM250-315	-	-	491802	168.26
300	1/16x90°	II	130	63	44.5	20	16	30	-	1/2"	-	D12PSH	656315	144.83	-	-
300	1/16x90°	I	140	90	60	25.5	30	35	-	M20	4.70	242203/F	-	-	491133	189.88
315	1/16x90°	I	120	70	50	21	-	30	-	M16	-	192204/S	-	-	491856	141.11
315	1/16x90°	I	140	70	50	21	-	30	-	M16	-	192204/S L140	-	-	491086	171.03
355-560	1/16x90°	II	165	63	44.5	21	19	40	-	5/8"	-	D15PSH	656320	218.36	-	-
400	3/32x90°	Ia	160	75	63	25	-	40	-	3/4"	-	HKM400	-	-	491804	405.79
400	3/32x90°	Ia	160	100	63	25	-	35	-	M18	-	HKM400S	-	-	491806	349.96
400	3/32x90°	I	160	80	60	25.5	-	40	-	M18	-	192205/S	-	-	491090	223.69
400-500	3/32x90°	Ia	172	63	63	25	-	38	-	M20	-	HKM400-500L6.75A	-	-	491820	366.30
400-500	3/32x90°	I	200	90	60	25.5	-	35	-	M20	-	242204/F L200	-	-	491862	292.72
400-500	3/32x90°	I	250	90	60	25.5	-	35	-	M20	-	242204/F L250	-	-	491864	357.85
400-500	3/32x90°	I	155	90	60	25.5	30	35	-	M20	6.40	242204/F	-	-	491135	213.32
500	3/32x90°	Ia	160	75	63	25	-	40	-	3/4"	-	HKM500	-	-	491808	403.98
500	3/32x90°	Ia	200	100	63	25	-	40	-	M18	-	HKM500S	-	-	491810	478.93
500	3/32x90°	III	170	60	60	28	27	38	38	M20	3.62	102210/A	-	-	491050	231.34
500	3/32x90°	III	170	60	60	25.5	27	38	38	M20	3.62	102210/A c25.5	-	-	491055	231.34
630	3/32x90°	Ia	210	88	88	30	-	63	-	1"	-	HKM630	-	-	491812	563.37
630	3/32x90°	Ia	241	88	75	30	-	65	-	M24	-	HKM630S	-	-	491814	619.85
630	3/32x90°	Ia	242	83	83	30	-	50	-	M24	-	HKM630AL9.50	-	-	491822	619.85
800	3/32x90°	Ia	210	88	88	30	-	63	-	1"	-	HKM800	-	-	491816	563.37
800	3/32x90°	Ia	300	88	75	30	-	65	-	M24	-	HKM800S	-	-	491818	704.30
800-1000	3/32x90°	Ia	318	83	83	30	-	50	-	M24	-	HKM800-1000AL12.5	-	-	491824	732.48