

Kinik Ceramic Straight Cup Wheels

Shape D Straight Cup

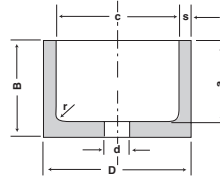

D	B	d	a	c	r	s	CSKG60J Code No.	Price \$
4	2	20mm	1-9/16	3-1/2	3/16	1/4	635075	66.69

Kinik Ceramic Shape B Saucer Type Grinding Wheels

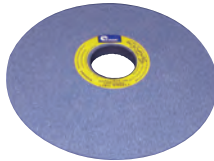
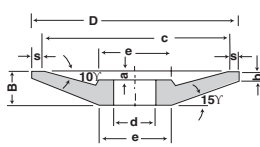

D	B	d	a	b	c	e	s	CSKG60K Code No.	Price \$
6	5/8	1-1/4	1/4	1/8	5-3/8	2	5/16	635095	91.90

Kinik Ceramic Shape E Flaring Cup Grinding Wheels

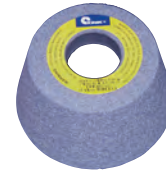
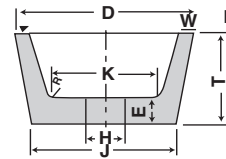

D	T	H	W	E	J	K	CSKG60K Code No.	Price \$
4	2	1-1/4	6 mm	1/2	3	2-1/2	635085	66.69
5	2	1-1/4	8 mm	1/2	4	3	635090	91.96

Kinik Aluminum Oxide Surface Grinding Wheels

Peripheral Surface Grinding

Surface grinding with straight or recessed wheels on machines with a rotating or reciprocating table results in a larger contact area than in cylindrical grinding. Therefore it is necessary to use softer grade wheels, particularly when large diameter and/or wide wheels are used.

When grinding a large number of components, the grinding is not continuous. In this case the components tend to dress the wheel, so a harder grade wheel should be used.



WA
White Aluminum Oxide



PA
Pink Aluminum Oxide



Dimensions	Structure WA46J	Price \$	WA60J	Price \$	WA80J	Price \$	PA46J	Price \$	PA60J	Price \$
6x1/4x1-1/4	635280	31.95	635282	31.95	635284	31.95	-	-	-	-
6x1/2x1-1/4	635288	36.79	635290	36.79	635292	36.79	-	-	-	-
7x1/4x1-1/4	635296	44.47	635298	44.47	635300	44.47	-	-	-	-
7x1/2x1-1/4	635306	45.09	635308	47.81	635310	47.81	635812	50.90	-	-
8x1/4x1-1/4	635314	54.01	635316	54.01	635318	54.01	-	-	-	-
8x1/2x1-1/4	635324	56.62	635326	56.62	635328	56.64	635820	63.20	635822	63.20
8x3/4x1-1/4	635334	73.30	635336	69.61	635338	73.27	635824	80.01	-	-
8x1x1-1/4	635344	83.48	635346	83.48	635348	83.48	-	-	-	-
8x3/4x2	635352	73.27	635354	73.27	635356	73.27	-	-	-	-
8x1x2	635360	83.48	635362	83.48	-	-	635836	89.80	635838	89.80
10x1/2x3	635364	104.46	635366	104.46	-	-	-	-	-	-
10x3/4x3	635368	113.06	635370	113.06	635372	114.11	-	-	-	-
10x1x3	635376	119.80	635378	119.80	635379	119.80	635848	133.03	-	-
12x3/4x3	635380	168.11	635382	164.71	635384	164.71	-	-	635854	180.05
12x1x3	635386	193.88	635388	193.88	-	-	-	-	-	-
12x1x5	635390	193.88	635392	193.88	-	-	-	-	-	-
12x1-1/2x5	635394	227.96	635396	227.97	-	-	-	-	-	-
14x1x5	635402	227.97	635404	227.97	635406	227.97	-	-	-	-
14x1-1/2x5	635408	292.99	635410	294.40	-	-	-	-	-	-
14x2x5	635411	385.77	635414	385.77	-	-	-	-	-	-
RECESSED 2A BOTH SIDES										
12x2x3 2A 6x3/8	635398	294.40	635399	284.98	-	-	635872	322.58	-	-
12x2x5 2A 7-1/4x1/2	635400	294.40	635401	284.98	-	-	-	-	-	-
14x2x5 2A 8x3/8	635412	405.47	635418	386.12	-	-	635880	433.67	-	-