

Multi-functional 45° Chamfer Tool



- Uses**
- Centering
 - Grooving
 - Chamfering

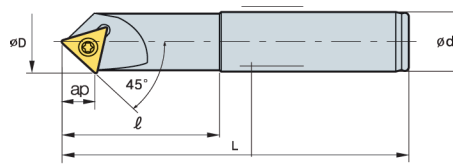

Fig. 1

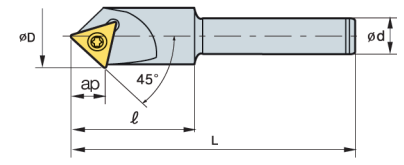

Fig. 2

*AR: -12~15° (inch)

Designation	Code No.	Price \$	ØD	Ød	l	L	ap	Fig.	Insert
CTP45 1600R-S050	147543	177.07	0.87	0.50	1.6	3.5	0.4	2	TWX16R-KC
CTP45 1600R-S075	147548	152.84	0.87	0.75	2.0	4.5	0.4	1	
CTP45 1600R-L075	147552	145.37	0.87	0.75	2.4	8.0	0.4	1	
CTP45 2200R-S050	147930	202.38	1.14	0.50	1.6	3.5	0.6	2	TWX22R-KC
CTP45 2200R-S100	147931	170.24	1.14	1.00	2.0	4.5	0.6	1	
CTP45 2200R-L100	147932	170.71	1.14	1.00	2.4	8.0	0.6	1	

Available Insert

TWX	Designation
	TWX16R-KC TWX22R-KC

Parts

Screw	Wrench
FTNA0408 146948 \$ 6.65	TW15L 148225 \$ 2.49

Indexable Countersink End Mills

45°, 60°, 82° and 90°,
RH Cut with Weldon Shank

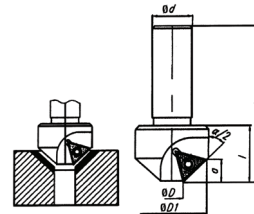

Cutter Body ØD Min.	ØD1 Max.	Shank Dia. Ød	a	l	L	Angle	No. of Inserts	Insert Style	Cutter Code No.	Cutter Price \$	Locking Screw Code No.	Locking Screw Price \$	Torx Key Code No.	Torx Key Price \$
1/2	31/32	1/2	0.559	1	2-1/2	45°	1	TDGW-321	-	-	143762	1.32	143752	8.78
3/4	1-15/64	3/4	0.559	1-1/4	3-1/2	45°	1	TDGW-321	-	-	143762	1.32	143752	8.78
1/4	21/32	3/8	0.335	1	2-1/4	60°	1	TDGW-21.51	-	-	143790	29.41	143792	8.10
1/2	1-1/8	1/2	0.524	1	2-1/2	60°	1	TDGW-321	-	-	143762	1.32	143752	8.78
3/4	1-3/8	3/4	0.524	1-1/4	3-1/2	60°	3	TDGW-321	-	-	143762	1.32	143752	8.78
1/4	51/64	3/8	0.291	1	2-1/4	82°	1	TDGW-21.51	-	-	143790	29.41	143792	8.10
1/2	1-11/32	1/2	0.453	1	2-1/2	82°	1	TDGW-321	-	-	143762	1.32	143752	8.78
3/4	1-9/16	3/4	0.453	1-1/4	3-1/2	82°	3	TDGW-321	-	-	143762	1.32	143752	8.78
1/4	53/64	3/8	0.272	1	2-1/4	90°	1	TDGW-21.51	-	-	143790	29.41	143792	8.10
1/2	1-25/64	1/2	0.425	1	2-1/2	90°	1	TDGW-321	-	-	143762	1.32	143752	8.78
3/4	1-41/64	3/4	0.425	1-1/4	3-1/2	90°	3	TDGW-321	-	-	143762	1.32	143752	8.78

➤ P.E103

60° Indexable Dovetail Milling Cutter

RH Cut with Weldon Shank
Note: Cutters are furnished without inserts.

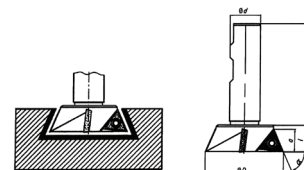

Cutting Dia. ØD	Shank Dia. Ød	Cutting Length a	l	Overall Length L	No. of Inserts	Insert Style	Locking Screw Code No.	Locking Screw Price \$	Torx Key Code No.	Torx Key Price \$
1/2	3/8	0.325	0.142	2.300	1	TDGW-21.5	143790	29.41	143792	8.10
3/4	3/8	0.325	0.202	2.390	2	TDGW-21.5	143790	29.41	143792	8.10
1	1/2	0.325	0.375	2-5/8	3	TDGW-21.5	143790	29.41	143792	8.10
1-3/8	5/8	0.510	0.550	2.862	3	TDGW-32	143762	1.32	143752	8.78
1-7/8	7/8	0.510	0.550	3	3	TDGW-32	143762	1.32	143752	8.78
2-1/4	1	0.700	0.750	3-1/2	3	TDGW-43	-	-	143752	8.78

➤ P.E103