

CAT40 Shell Mill Holders

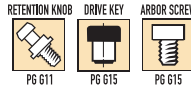

- DIN coolant option - standard
- All ground body, nose, pilot, flange
- TIR, 0.0001" / 0.003mm OD to ID
- AT2 Taper Accuracy
- Certified Steel
- RFID chip hole

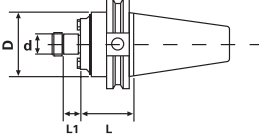

Taper	d	L	D	L1	Key Size	Arbor Thread	Code No.	Price \$
CT40	1/2	1.75	1.38	0.57	1/4	1/4-28	531190	162.13
CT40	3/4	1.75	1.75	0.67	5/16	3/8-24	531192	146.84
CT40	3/4	4.00	1.75	0.67	5/16	3/8-24	531194	196.80
CT40	3/4	6.00	1.75	0.67	5/16	3/8-24	531195	221.27
CT40	1	1.75	2.38	0.67	3/8	1/2-20	531196	146.84
CT40	1	4.00	2.38	0.67	3/8	1/2-20	531198	196.80
CT40	1	6.00	2.38	0.67	3/8	1/2-20	531199	221.27
CT40	1-1/4	2.00	2.88	0.67	1/2	5/8-18	531200	156.01
CT40	1-1/4	4.00	2.88	0.67	1/2	5/8-18	531202	221.27
CT40	1-1/4	6.00	2.88	0.67	1/2	5/8-18	531203	227.39
CT40	1-1/2	2.00	3.80	0.93	5/8	3/4-16	531204	172.33
CT40	1-1/2	4.00	3.80	0.93	5/8	3/4-16	531206	246.77

CAT40 DUAL CONTACT Shell Mill Holders



- DIN coolant through the flange option - Standard
- Improves rigidity and reduces vibration allowing for increased feed rates and increased tool life
- All ground body, nose, pilot, flange
- TIR, 0.0001" / 0.003mm OD to ID
- AT2 Taper Accuracy
- Certified Steel
- RFID chip hole

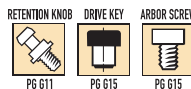
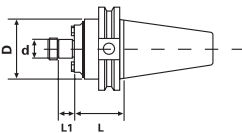
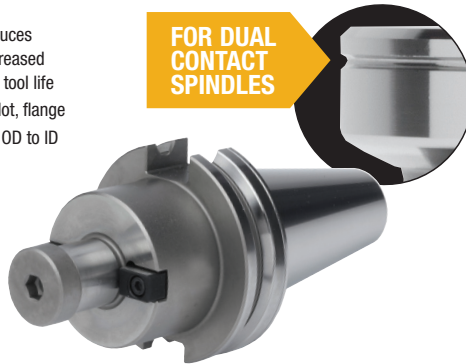

Taper	d	L	D	L1	Key Size	Arbor Thread	Code No.	Price \$
CT40	3/4	1.75	1.75	0.67	5/16	3/8-24	521192	175.98
CT40	3/4	4.00	1.75	0.67	5/16	3/8-24	521194	255.65
CT40	3/4	6.00	1.75	0.67	5/16	3/8-24	521195	285.41
CT40	1	1.75	2.38	0.67	3/8	1/2-20	521196	179.48
CT40	1	4.00	2.38	0.67	3/8	1/2-20	521198	255.65
CT40	1	6.00	2.38	0.67	3/8	1/2-20	521199	289.79
CT40	1-1/4	2.00	2.88	0.67	1/2	5/8-18	521200	192.61
CT40	1-1/4	4.00	2.88	0.67	1/2	5/8-18	521202	297.67
CT40	1-1/2	2.00	3.80	0.93	5/8	3/4-16	521204	210.12
CT40	1-1/2	4.00	3.80	0.93	5/8	3/4-16	521206	315.18

CAT50 Shell Mill Holders



- DIN coolant option - Standard
- All ground body, nose, pilot, flange
- TIR, 0.0001" / 0.003mm OD to ID
- AT2 Taper Accuracy
- Certified Steel
- RFID chip hole

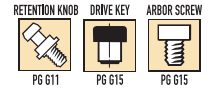
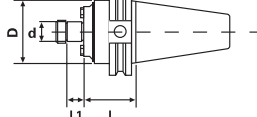

Taper	d	L	D	L1	Key Size	Arbor Thread	Code No.	Price \$
CT50	3/4	1.75	2.00	0.67	5/16	3/8-24	531208	175.39
CT50	3/4	4.00	2.00	0.67	5/16	3/8-24	531210	227.39
CT50	3/4	6.00	2.00	0.67	5/16	3/8-24	531212	291.63
CT50	3/4	8.00	2.00	0.67	5/16	3/8-24	531214	361.99
CT50	1	1.75	2.75	0.69	3/8	1/2-20	531216	182.53
CT50	1	4.00	2.75	0.69	3/8	1/2-20	531218	246.77
CT50	1	6.00	2.75	0.69	3/8	1/2-20	531220	317.13
CT50	1	8.00	2.75	0.69	3/8	1/2-20	531222	361.99
CT50	1-1/4	1.75	2.88	0.69	1/2	5/8-18	531224	208.02
CT50	1-1/4	4.00	2.88	0.69	1/2	5/8-18	531226	246.77
CT50	1-1/4	6.00	2.88	0.69	1/2	5/8-18	531228	317.13
CT50	1-1/4	8.00	2.88	0.69	1/2	5/8-18	531230	386.47
CT50	1-1/2	2.00	3.80	0.93	5/8	3/4-16	531232	208.02
CT50	1-1/2	4.00	3.80	0.93	5/8	3/4-16	531234	246.77
CT50	1-1/2	6.00	3.80	0.93	5/8	3/4-16	531236	317.13
CT50	1-1/2	8.00	3.80	0.93	5/8	3/4-16	531238	412.98
CT50	2	2.00	4.38	0.93	3/4	1-14	531240	261.04
CT50	2	4.00	4.38	0.93	3/4	1-14	531242	466.00
CT50	2	6.00	4.38	0.93	3/4	1-14	531244	560.84

CAT50 DUAL CONTACT Shell Mill Holders



- DIN Coolant through the flange option - Standard
- Improves rigidity and reduces vibration allowing for increased feed rates and increased tool life
- All ground body, nose, pilot, flange
- TIR, 0.0001" / 0.003mm OD to ID
- AT2 Taper Accuracy
- Certified Steel
- RFID chip hole

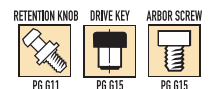
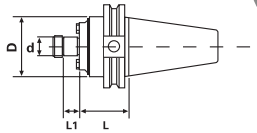

Taper	d	L	D	L1	Key Size	Arbor Thread	Code No.	Price \$
CT50	3/4	1.75	2.00	0.67	5/16	3/8-24	521208	232.88
CT50	3/4	4.00	2.00	0.67	5/16	3/8-24	521210	294.17
CT50	3/4	6.00	2.00	0.67	5/16	3/8-24	521212	367.71
CT50	3/4	8.00	2.00	0.67	5/16	3/8-24	521214	488.53
CT50	1	1.75	2.75	0.69	3/8	1/2-20	521216	213.62
CT50	1	4.00	2.75	0.69	3/8	1/2-20	521218	315.18
CT50	1	6.00	2.75	0.69	3/8	1/2-20	521220	393.98
CT50	1	8.00	2.75	0.69	3/8	1/2-20	521222	488.53
CT50	1-1/4	1.75	2.88	0.69	1/2	5/8-18	521224	213.62
CT50	1-1/4	4.00	2.88	0.69	1/2	5/8-18	521226	315.18
CT50	1-1/4	6.00	2.88	0.69	1/2	5/8-18	521228	393.98
CT50	1-1/4	8.00	2.88	0.69	1/2	5/8-18	521230	488.53
CT50	1-1/2	2.00	3.80	0.93	5/8	3/4-16	521232	232.88
CT50	1-1/2	4.00	3.80	0.93	5/8	3/4-16	521234	315.18
CT50	1-1/2	6.00	3.80	0.93	5/8	3/4-16	521236	393.98
CT50	1-1/2	8.00	3.80	0.93	5/8	3/4-16	521238	488.53
CT50	2	2.00	4.38	0.93	3/4	1-14	521240	400.10
CT50	2	4.00	4.38	0.93	3/4	1-14	521242	562.95