

CAT50 Face Mill Holders

- All ground body
- 4 bolts, 5/8-11
- 4" bolt circle
- AT2 Taper Accuracy
- RFID chip hole

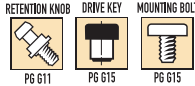
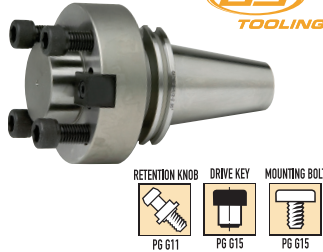
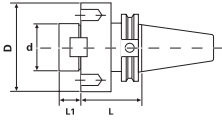

Taper	d	L	D	L1	Key Size	Code No.	Price \$
CT50	2	2.95	5.06	0.86	3/4	531246	298.36
CT50	2-1/2	2.95	5.00	1.18	1	531248	307.20

HSK63A Shell Mill Holders

- High rigidity and torque transmission
- All ground body, nose, pilot, flange
- TIR, 0.0001" / 0.003mm OD to ID
- Certified Steel
- AT2 Taper Accuracy
- RFID chip hole

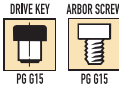
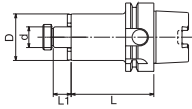

Taper	d	L	D	L1	Key Size	Arbor Thread	Code No.	Price \$
HSK63A	3/4	3.00	1.693	0.669	5/16	3/8-24	536082	433.37
HSK63A	3/4	5.00	1.693	0.669	5/16	3/8-24	536084	433.37
HSK63A	1	3.00	2.165	0.669	3/8	1/2-20	536086	433.37
HSK63A	1	5.00	2.165	0.669	3/8	1/2-20	536088	433.37
HSK63A	1-1/4	3.00	2.756	0.669	1/2	5/8-18	536090	433.37
HSK63A	1-1/4	5.00	2.756	0.669	1/2	5/8-18	536092	433.37

BT Taper Shell Mill Holders

- DIN coolant option - standard
- All ground body, nose, pilot, flange
- TIR, 0.0001" / 0.003mm OD to ID
- AT2 Taper Accuracy
- Certified Steel
- RFID chip hole

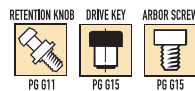
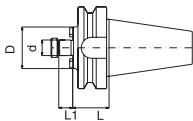

Taper	d	L	D	L1	Key Size	Arbor Thread	Code No.	Price \$
BT30								
BT30	1/2	1.19	1.38	0.57	1/4	1/4-28	532080†	159.07
BT30	3/4	1.19	2.00	0.67	5/16	3/8-24	532082†	143.78
BT30	1	1.77	2.38	0.69	3/8	1/2-20	532084†	125.42
BT40								
BT40	1/2	1.75	1.38	0.57	1/4	1/4-28	532086	178.45
BT40	3/4	1.75	1.75	0.67	5/16	3/8-24	532088	169.27
BT40	3/4	4.00	1.75	0.67	5/16	3/8-24	532111	202.92
BT40	3/4	6.00	1.75	0.67	5/16	3/8-24	532114	280.42
BT40	1	1.75	2.38	0.67	3/8	1/2-20	532090	169.27
BT40	1	4.00	2.38	0.67	3/8	1/2-20	532115	189.66
BT40	1	6.00	2.38	0.67	3/8	1/2-20	532117	244.73
BT40	1-1/4	2.00	2.88	0.67	1/2	5/8-18	532092	209.04
BT40	1-1/4	4.00	2.88	0.67	1/2	5/8-18	532119	267.16
BT40	1-1/4	6.00	2.88	0.67	1/2	5/8-18	532121	275.32
BT40	1-1/2	2.00	3.80	0.92	5/8	3/4-16	532094	267.16
BT50								
BT50	1	1.75	2.75	0.69	3/8	1/2-20	532103	339.56
BT50	1-1/4	1.75	2.88	0.69	1/2	5/8-18	532104	339.56
BT50	1-1/2	1.75	3.80	0.92	5/8	3/4-16	532105	285.52
BT50	2	1.75	4.38	0.92	3/4	1-14	532107	408.90

† Not DIN Coolant

HSK100A Shell Mill Holders

- High rigidity and torque transmission
- All ground body, nose, pilot, flange
- TIR, 0.0001" / 0.003mm OD to ID
- Certified Steel
- AT2 Taper Accuracy
- RFID chip hole

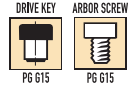
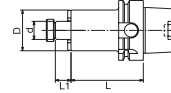

Taper	d	L	D	L1	Key Size	Arbor Thread	Code No.	Price \$
HSK100A	3/4	4.00	1.693	0.669	5/16	3/8-24	536094	504.75
HSK100A	3/4	6.00	1.693	0.669	5/16	3/8-24	536096	541.46
HSK100A	1	4.00	2.165	0.669	3/8	1/2-20	536098	504.75
HSK100A	1	6.00	2.165	0.669	3/8	1/2-20	536100	541.46
HSK100A	1-1/2	4.00	3.504	0.902	5/8	3/4-16	536106	524.13
HSK100A	1-1/2	6.00	3.504	0.902	5/8	3/4-16	536108	586.33

NMTB Taper Shell Mill Holders

- All ground body, nose, pilot, flange
- TIR, 0.0001" / 0.003mm OD to ID
- Certified Steel

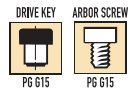
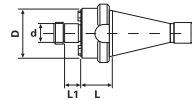

Taper	d	L	D	L1	Key Size	Arbor Thread	Code No.	Price \$
NMTB40								
NMTB40	1/2	0.87	1.38	0.57	1/4	1/4-28	534130	149.71
NMTB40	3/4	0.87	1.94	0.67	5/16	3/8-24	534132	149.71
NMTB40	1	1.31	2.38	0.67	3/8	1/2-20	534134	149.71
NMTB40	1-1/4	1.50	2.88	0.67	1/2	5/8-18	534136	149.71
NMTB40	1-1/2	1.63	3.50	0.93	5/8	3/4-16	534138	149.71
NMTB50								
NMTB50	3/4	1.25	2.00	0.67	5/16	3/8-24	534140	188.49
NMTB50	1	1.88	2.38	0.67	3/8	1/2-20	534142	194.16
NMTB50	1-1/4	1.88	2.88	0.67	1/2	5/8-18	534144	197.81
NMTB50	1-1/2	1.88	3.50	0.93	5/8	3/4-16	534146	217.38
NMTB50	2	1.88	4.38	0.93	3/4	1-14	534148	219.38

NMTB50 Taper Face Mill Holders

- All ground body
- 4 bolts, 5/8-11
- 4" bolt circle

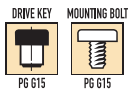
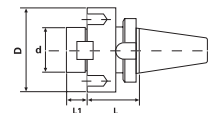

Taper	d	L	D	L1	Key Size	Code No.	Price \$
NMTB50	2-1/2	3.00	5.00	1.18	1	534152	219.38

R8 Shell Mill Holders

- All ground body, nose, pilot, flange
- TIR, 0.0001" / 0.003mm OD to ID
- Certified Steel

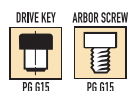
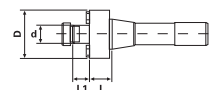

Taper	d	L	D	L1	Key Size	Arbor Thread	Code No.	Price \$
R8	1/2	1.00	1.38	0.57	1/4	1/4-28	534154	89.83
R8	3/4	1.00	2.00	0.69	5/16	3/8-24	534156	89.83
R8	1	1.00	2.38	0.69	3/8	1/2-20	534158	93.95
R8	1-1/4	1.00	2.88	0.69	1/2	5/8-18	534160	96.43
R8	1-1/2	1.75	3.50	0.94	5/8	3/4-16	534162	107.75