

Replacement Drive Keys



Spigot Dia.	Description	Code No.	Price \$
1/2	Two 1/4 Drive keys	534164	15.43
3/4	Two 5/16	534166	18.16
1	Two 3/8	534168	22.28
1-1/4	Two 1/2	534170	24.62
1-1/2	Two 5/8	534172	26.70
2	Two 3/4	534174	32.82
2-1/2	Two 1	534176	28.16

Replacement Arbor Screws



Thread Size	Size of Holder	Code No.	Price \$
5/8-11	Face Mill Mounting Bolt	534178	14.45
1/4-28	1/2	534180	14.45
3/8-24	3/4	534182	15.09
1/2-20	1	534184	17.39
5/8-18	1-1/4	534186	19.72
3/4-16	1-1/2	534188	30.53
1-14	2	534190	43.26

Shell End Mill Arbors For Morse Taper Spindles



Style "B" with Draw Bar End

Style "A" with Tang End

Machined from one piece forgings, hardened and precisely ground; hardness 52-56 HRC. Maximum misalignment of taper in shank, in which the tool is fixed: 0.0006". The drive keys are pressed in.

- Draw bar threads for #4 MT: 1/2"-13
- Draw bar threads for #5 MT: 5/8"-11

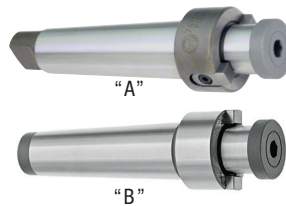

Draw Bar Arbor No.	M.T.	For Bore Dia.	Dia. for Range of Shell End Mill	Style "B" Draw Bar End Code No.	Price \$	Style "A" Tang End Code No.	Price \$
MT4-1/2	4	1/2	1-1/4 to 1-1/2	410405	215.35	410305	275.81
MT4-3/4	4	3/4	1-3/4 to 2	410410	226.58	410310	329.39
MT4-1	4	1	2-1/4 to 2-3/4	-	-	410315	351.85
MT4-1-1/4	4	1-1/4	3 to 3-1/2	-	-	410320	399.25
MT4-1-1/2	4	1-1/2	4 to 5	-	-	410325	419.23
MT5-1-1/4	5	1-1/4	3 to 3-1/2	410435	312.02	410335	402.12
MT5-1-1/2	5	1-1/2	4 to 5	-	-	410340	446.67

CAT Taper Stub Arbors



- Each arbor equipped with 1/8, 1/4, 3/8, 1/2 spacers

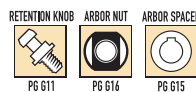
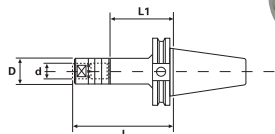

Taper	d	L	D	L1	Code No.	Price \$
CAT40						
CT40	1	6.17	1.50	4.00	531580	168.22
CT40	1-1/4	6.29	1.75	4.00	531582	171.88
CT40	1-1/2	6.60	2.12	4.00	531584	183.96
CAT50						
CT50	1	6.17	1.50	4.00	531586	250.62
CT50	1-1/4	6.28	1.75	4.00	531588	265.76
CT50	1-1/2	6.60	2.12	4.00	531590	273.72

Face Mill Holders



Made of selected steel, hardened and precision ground

- These holders have 4 mounting holes and bolts with 5/8-11 threads on a 4" bolt circle

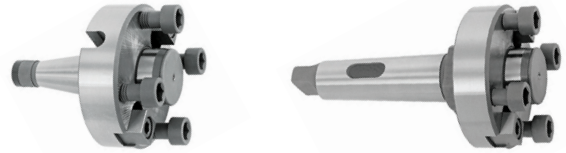

Taper	Fore Bore Dia.	Length of Arbor	Screw Size	Code No.	Price \$
ISA40	2	6.20	5/8-11	410190	950.74
ISA40	2-1/2	6.20	5/8-11	410192	943.24
ISA50	2	7.56	5/8-11	410194	1,032.49
ISA50	2-1/2	7.56	5/8-11	410196	1,063.03
MT 5	2	9.57	5/8-11	410202	1,521.36
MT 5	2-1/2	9.57	5/8-11	410204	1,569.60
MT 6	2	13.58	5/8-11	410206	1,674.24
MT 6	2-1/2	13.58	5/8-11	410208	1,963.85

Replacement Stub Arbor Spacers



Description	Code No.	Price \$
1/8" Spacer for 3/4" Holder	534568	11.02
1/4" Spacer for 3/4" Holder	534570	11.02
3/8" Spacer for 3/4" Holder	534572	11.02
1/2" Spacer for 3/4" Holder	534574	11.02
1/8" Spacer for 1" Holder	534576	11.27
3/8" Spacer for 1" Holder	534580	11.27
1/8" Spacer for 1-1/4" Holder	534584	11.79
3/8" Spacer for 1-1/4" Holder	534588	12.25
1/8" Spacer for 1-1/2" Holder	534592	12.75
3/8" Spacer for 1-1/2" Holder	534596	12.27
1/2" Spacer for 1-1/2" Holder	534598	12.27

Slitting Saw Arbor



Diameter of Arbor (in.)	Length (in.)	Fits Following Hole Size (in.)	Code No.	Price \$
1/2	2-9/16	1/2, 5/8, 3/4, 7/8, 1	400150	95.48

R8 Stub Milling Machine Arbor



To fit Bridgeport and other popular machines. Furnished complete with assorted spacers.



Arbor No.	Arbor Dia. (in.)	Length of Shoulder to Nut (in.)	Thread of Nut	Code No.	Price \$
R8S1	1	2	1 - 14	400350	456.65