

NMTB Taper TG Collet Chucks

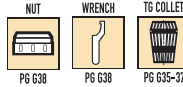

Taper	Collet Series	Collet Range	L	L1	D	Tightening Torque (Nm)	Code No.	Price \$
NMTB40	TG100	3/64-1	3.00	2.12	2.50	81.3	534304	118.36
NMTB50	TG75	3/64-3/4	3.00	1.61	1.89	81.3	534308	143.23
NMTB50	TG100	3/64-1	3.50	2.12	2.50	81.3	534310	189.21

R8 Taper TG Collet Chuck

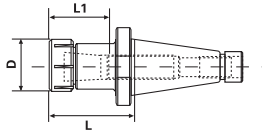
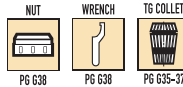
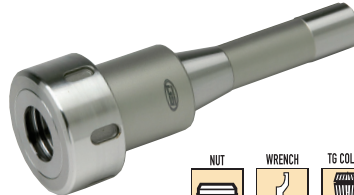
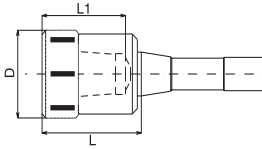

Taper	Collet Series	Collet Range	L	L1	D	Tightening Torque (Nm)	Code No.	Price \$
R8	TG100	3/64-1	3.25	2.17	2.50	81.3	534314	128.49

Morse Taper TG Collet Chucks

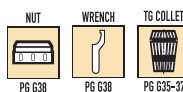
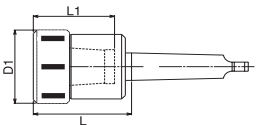

Taper	Collet Series	Collet Range	L	L1	D	Tightening Torque (Nm)	Code No.	Price \$
MT3	TG100	3/64-1	3.25	2.73	2.50	81.3	534322	203.58
MT4	TG100	3/64-1	3.25	2.73	2.50	81.3	534324	214.19

Straight Shank TG Collet Chucks

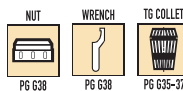
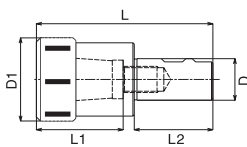

Shank Dia.	Collet Series	Collet Range	L	L1	L2	D1	Tightening Torque (Nm)	Code No.	Price \$
1-1/2	TG100	3/64-1	9.00	2.73	6.00	2.50	81.3	534320	152.43

TG75 Standard & Sealed Collets



- 1/64" collapse per collet
- 0.0005" in TIR precision per DIN 6341
- 80 ft/lbs maximum tightening torque

Sealed Collets

- Sealed for coolant-through applications
- Pressure resistance tested to 1000 psi
- Sealed with rubber



REGULAR

SEALED

Size (in.)	Regular Code No.	Price \$	Sealed Code No.	Price \$
3/64	334790	29.11	-	-
1/16	334791	29.11	-	-
5/64	334792	29.11	-	-
3/32	334800	29.11	-	-
7/64	334801	29.11	-	-
1/8	334802	28.26	334843	54.81
9/64	334803	29.11	334844	54.81
5/32	334804	29.11	334845	54.81
11/64	334805	28.26	334846	54.81
3/16	334806	29.11	334847	54.81
13/64	334807	28.26	334848	54.81
7/32	334808	29.11	334849	54.81
15/64	334809	28.26	334850	54.81
1/4	334810	28.26	334851	54.81
17/64	334811	28.26	334852	54.81
9/32	334812	29.11	334853	54.81
19/64	334813	28.26	334854	54.81
5/16	334814	29.11	334855	54.81
21/64	334815	28.26	334856	54.81
11/32	334816	28.26	334857	54.81
23/64	334817	29.11	334858	54.81
3/8	334818	29.11	334859	54.81
25/64	334819	29.11	334860	54.81
13/32	334820	28.26	334861	54.81
27/64	334821	29.11	334862	54.81
7/16	334822	29.11	334863	54.81
29/64	334823	29.11	334864	54.81
15/32	334824	28.26	334865	54.81
31/64	334825	29.11	334866	54.81
1/2	334826	28.26	334867	54.81
33/64	334827	29.11	334868	54.81
17/32	334828	28.26	334869	54.81
35/64	334829	29.11	334870	54.81
9/16	334830	29.11	334871	54.81
37/64	334831	29.11	334872	54.81
19/32	334832	28.26	334873	54.81
39/64	334833	29.11	334874	54.81
5/8	334834	29.11	334875	54.81
41/64	334835	29.11	334876	54.81
21/32	334836	28.26	334877	54.81
43/64	334837	29.11	334878	54.81
11/16	334838	28.26	334879	54.81
45/64	334839	29.11	334880	54.81
23/32	334840	29.11	334881	54.81
47/64	334841	29.11	334882	54.81
3/4	334842	29.11	334883	54.81

• See page G38 for Dimensional Data