

## Replacement TG Chuck Nuts



Description	Tightening Torque (Nm)	Code No.	Price \$
*TG75 Nut	81.3	534760	<b>80.56</b>
*TG100 Nut	81.3	534762	<b>53.02</b>
*TG150 Nut	94.9	534764	<b>83.04</b>
TG75 Nut, Solid	81.3	534830	<b>80.56</b>
TG100 Nut, Solid	81.3	534832	<b>53.02</b>

\* Photo Shown / This style is supplied with chuck

## TG Chuck Wrenches



Description	Code No.	Price \$
Fits TG75 Chuck	534772	<b>48.95</b>
Fits TG100 Chuck	534774	<b>29.57</b>
Fits TG150 Chuck	534776	<b>52.22</b>

## Replacement TG Backup Screws



Description	Code No.	Price \$
TG75	534778	<b>8.94</b>
TG100	534782	<b>8.61</b>
TG150	534786	<b>10.17</b>
TG150 Coolant	534788	<b>11.65</b>

## TG Collet Dimensional Data

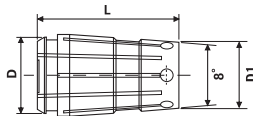

Style	D	D1	L	Collet Range
TG25	0.425	0.325	0.709	3/64-1/4
TG50	0.760	0.594	1.437	1/8-1/2
TG75	1.063	0.871	1.844	3/64-3/4
TG100	1.278	1.121	2.386	3/64-1
TG150	1.875	1.678	3.000	1/2-1-1/2

## CAT40 Milling Chucks

- DIN coolant through the flange at no extra charge
- Rough milling or 'hogging' operations
- Improved tool life over regular end mill holders
- '360°' gripping contact
- Extreme rigidity over taper collets
- TIR, 0.0002"
- AT2 Taper Accuracy
- RFID chip hole

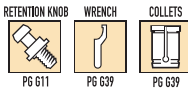
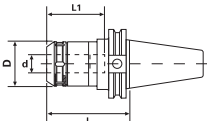

Taper	Collet Series	Collet Range	d	L	L1	D	Tightening Torque (Nm)	Code No.	Price \$
CT40	GS 3/4	0.125-0.750	0.750	3.54	3.15	2.05	50-70	531253	<b>526.68</b>
CT40	GS 3/4	0.125-0.750	0.750	4.14	3.15	2.05	50-70	531250	<b>526.68</b>
CT40	GS 1	0.125-1.00	1.00	3.54	3.15	2.41	50-70	531255‡	<b>526.68</b>
CT40	GS 1	0.125-1.00	1.00	4.14	3.15	2.41	50-70	531254	<b>526.68</b>
CT40	GS 1-1/4	0.187-1.25	1.25	3.54	3.34	2.88	60-80	531257‡	<b>526.68</b>
CT40	GS 1-1/4	0.187-1.25	1.25	4.14	3.34	2.88	60-80	531256	<b>526.68</b>
CT40	GS 1-1/4	0.187-1.25	1.25	5.32	4.73	2.88	60-80	531258	<b>544.50</b>

‡ Not DIN Coolant

## CAT40 DUAL CONTACT Milling Chucks

- Improves rigidity and reduces vibration allowing for increased feed rates and increased tool life
- DIN coolant through the flange at no extra charge
- Rough milling or 'hogging' operations
- '360°' gripping contact
- Improved tool life over regular end mill holders
- Extreme rigidity over taper collets
- TIR, 0.0002"
- RFID chip hole
- AT2 Taper Accuracy

FOR DUAL CONTACT SPINDLES

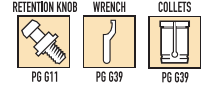
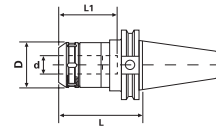

Taper	Collet Series	Collet Range	d	L	L1	D	Tightening Torque (Nm)	Code No.	Price \$
CT40	GS 3/4	0.125-0.750	0.750	3.54	3.15	2.05	50-70	521253	<b>465.77</b>
CT40	GS 1	0.125-1.00	1.00	3.54	3.15	2.41	50-70	521255‡	<b>465.77</b>
CT40	GS 1-1/4	0.187-1.25	1.25	3.54	3.34	2.88	60-80	521257‡	<b>465.77</b>

‡ Not DIN Coolant

## BT Taper Milling Chucks

- TIR 0.0004"
- AT2 Taper Accuracy
- RFID chip hole

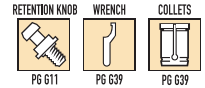
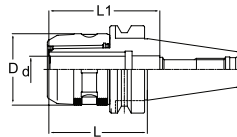

Taper	Collet Series	Collet Range	d	L	L1	D	Code No.	Price \$
<b>BT30</b>								
BT30	GS 3/4	0.125-0.750	0.750	3.55	3.15	2.05	532096‡	<b>526.68</b>
<b>BT40</b>								
BT40	GS 3/4	0.125-0.750	0.750	4.14	3.15	2.05	532098	<b>526.68</b>
BT40	GS 3/4	0.125-0.750	0.750	4.73	3.15	2.05	532100	<b>526.68</b>
BT40	GS 1	0.125-1.00	1.00	4.14	3.15	2.41	532102	<b>526.68</b>
BT40	GS 1-1/4	0.187-1.25	1.25	4.14	3.34	2.88	532104	<b>526.68</b>
<b>BT50</b>								
BT50	GS 1-1/4	0.187-1.25	1.25	4.20	3.34	2.88	532113	<b>677.16</b>

‡ Not DIN Coolant

## CAT50 Milling Chucks

- DIN coolant through the flange at no extra charge
- Rough milling or 'hogging' operations
- Improved tool life over regular end mill holders
- '360°' gripping contact
- Extreme rigidity over taper collets
- TIR, 0.0002"
- AT2 Taper Accuracy
- RFID chip hole

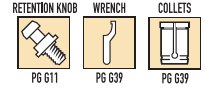
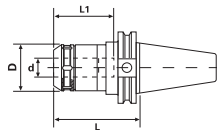

Taper	Collet Series	Collet Range	d	L	L1	D	Tightening Torque (Nm)	Code No.	Price \$
CT50	GS 3/4	0.125-0.750	0.750	4.14	3.15	2.05	50-70	531260	<b>677.16</b>
CT50	GS 3/4	0.125-0.750	0.750	5.32	3.15	2.05	50-70	531262	<b>688.05</b>
CT50	GS 3/4	0.125-0.750	0.750	6.49	3.15	2.05	50-70	531263	<b>688.05</b>
CT50	GS 1	0.125-1.00	1.00	4.14	3.15	2.41	50-70	531264	<b>677.16</b>
CT50	GS 1-1/4	0.187-1.25	1.25	3.54	4.73	2.88	60-80	531265	<b>677.16</b>
CT50	GS 1-1/4	0.187-1.25	1.25	4.14	4.73	2.88	60-80	531266	<b>677.16</b>
CT50	GS 1-1/4	0.187-1.25	1.25	5.32	4.73	2.88	60-80	531268	<b>688.05</b>
CT50	GS 1-1/4	0.187-1.25	1.25	6.49	4.73	2.88	60-80	531269	<b>688.05</b>