

## CAT40 DUAL CONTACT End Mill Holders

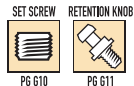

- Improves rigidity and reduces vibration allowing for increased feed rates and increased tool life
- DIN coolant option - standard
- All ground body, bore, nose, flange
- TIR, 0.0001" / 0.003mm OD to ID
- AT2 Taper Accuracy
- Certified Steel
- RFID chip hole

FOR DUAL CONTACT SPINDLES

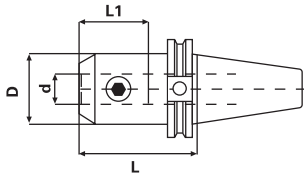
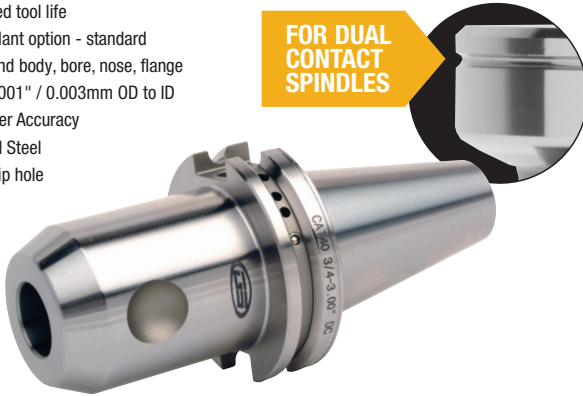

PREMIUM BALANCE  
G6.3 at 30,000rpm  
CERTIFICATE INCLUDED

Taper	Hole Dia. (d)	Gauge Length (L)	L1	D	Set Screw	Code No.	Price \$
CT40	1/2	2.50	2.56	1.38	7/16-20	521026	143.58
CT40	1/2	4.00	2.56	1.38	7/16-20	521028	143.58
CT40	1/2	5.00	2.56	1.38	7/16-20	521030	179.48
CT40	5/8	3.00	3.50	1.65	9/16-18	521034	156.71
CT40	5/8	4.00	3.50	1.65	9/16-18	521036	176.85
CT40	5/8	5.50	3.50	1.65	9/16-18	521038	192.61
CT40	3/4	3.00	3.86	1.75	5/8-18	521042	161.09
CT40	3/4	4.00	3.86	1.75	5/8-18	521044	161.09
CT40	3/4	5.50	3.86	1.75	5/8-18	521046	255.65
CT40	1	2.00	2.36	2.36	3/4-16	521054	177.73
CT40	1	4.00	4.21	2.36	3/4-16	521056	177.73
CT40	1	6.00	4.21	2.36	3/4-16	521058	306.43
CT40	1-1/4	2.00*	2.36	2.25	3/4-16	521060‡	181.23
CT40	1-1/4	4.00	3.54	2.48	3/4-16	521062	181.23
CT40	1-1/4	6.00	3.54	2.48	3/4-16	521064	306.43
CT40	1-1/2	4.50	2.95	2.99	3/4-16	521066	196.99

\* Stubby Length

‡ Not DIN Coolant

## CAT40 DIRECT COOLANT End Mill Holders



### NOW 3 COOLANT OPTIONS ALL IN ONE!

- Coolant through the spindle and body
- DIN coolant through flange option
- All ground body, bore, nose, flange
- Certified Steel
- TIR, 0.0001" / 0.003mm OD to ID
- AT2 Taper Accuracy
- RFID chip hole

DIRECT COOLANT

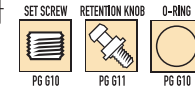
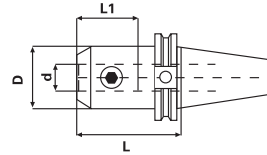
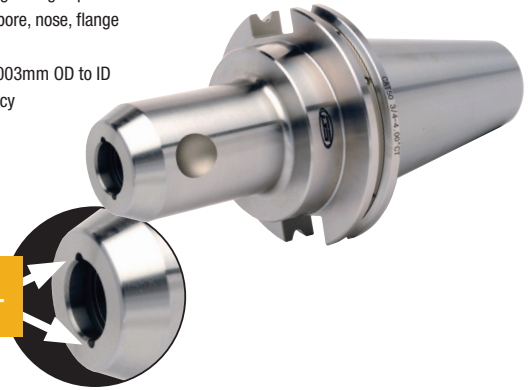

PREMIUM BALANCE  
G6.3 at 30,000rpm  
CERTIFICATE INCLUDED

Taper	Hole Dia. (d)	Gauge Length (L)	L1	D	Set Screw	Code No.	Price \$
CT40	1/4	1.38*	1.18	0.79	1/4-28	522014	148.32
CT40	1/4	2.50	1.18	0.79	1/4-28	522016	148.32
CT40	1/4	4.00	1.18	0.79	1/4-28	522018	201.72
CT40	5/16	1.38*	1.18	0.87	5/16-24	522022	148.32
CT40	5/16	2.50	1.18	0.87	5/16-24	522024	148.32
CT40	5/16	4.00	1.18	0.87	5/16-24	522026	201.72
CT40	3/8	1.38*	1.57	1.00	3/8-24	522030	148.32
CT40	3/8	2.50	1.57	1.00	3/8-24	522032	148.32
CT40	3/8	4.00	1.57	1.00	3/8-24	522034	201.72
CT40	3/8	5.00	1.57	1.00	3/8-24	522036	232.37
CT40	1/2	1.75*	2.56	1.38	7/16-20	522046	148.32
CT40	1/2	2.50	2.56	1.38	7/16-20	522048	148.32
CT40	1/2	4.00	2.56	1.38	7/16-20	522050	201.72
CT40	1/2	5.00	2.56	1.38	7/16-20	522052	254.12
CT40	5/8	1.75*	2.72	1.65	9/16-18	522056	148.32
CT40	5/8	3.00	2.56	1.65	9/16-18	522058	148.32
CT40	5/8	4.00	2.56	1.65	9/16-18	522060	148.32
CT40	3/4	1.75*	2.56	1.89	5/8-18	522066	148.32
CT40	3/4	3.00	2.56	1.75	5/8-18	522068	148.32
CT40	3/4	4.00	2.56	1.75	5/8-18	522070	201.72
CT40	3/4	5.50	2.56	1.75	5/8-18	522072	254.12
CT40	1	2.00*	2.36	2.25	3/4-16	522080	148.32
CT40	1	4.00	3.54	2.36	3/4-16	522082	148.32
CT40	1-1/4	2.00*	2.44	2.25	3/4-16	522088	148.32
CT40	1-1/4	4.00	3.54	2.48	3/4-16	522090	173.04
CT40	1-1/2	4.50	2.95	2.99	3/4-16	522094	177.98

\* Stubby Length

Spindle Taper Wipers  
Clean spindle holes easily  
and quickly!

See Page G91