

## CAT50 DIRECT COOLANT End Mill Holders

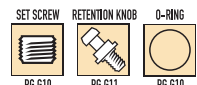

### NOW 3 COOLANT OPTIONS ALL IN ONE!

- Coolant through the spindle
- DIN coolant through flange option
- Coolant through the body
- All ground body, bore, nose, flange
- TIR, 0.0001" / 0.003mm OD to ID
- AT2 Taper Accuracy
- Certified Steel
- RFID chip hole

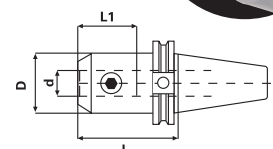

**PREMIUM BALANCE**  
**G6.3 at 25,000rpm**  
**CERTIFICATE INCLUDED**

Taper	Hole Dia. (d)	Gauge Length (L)	L1	D	Set Screw	Code No.	Price \$
CT50	1/4	2.50	1.18	0.79	1/4-28	522102	180.95
CT50	1/4	4.00	1.18	0.79	1/4-28	522104	214.57
CT50	5/16	4.00	1.26	0.87	5/16-24	522112	214.57
CT50	3/8	2.50	1.57	1.00	3/8-24	522118	180.95
CT50	3/8	4.00	1.57	1.00	3/8-24	522120	214.57
CT50	3/8	6.00	1.57	1.00	3/8-24	522122	236.32
CT50	3/8	8.00	1.26	1.00	3/8-24	522124	265.00
CT50	7/16	4.00	1.50	1.38	7/16-20	522130	214.57
CT50	1/2	1.75*	1.50	1.38	7/16-20	522134	180.95
CT50	1/2	2.63	1.77	1.38	7/16-20	522136	180.95
CT50	1/2	4.00	1.77	1.38	7/16-20	522138	222.48
CT50	1/2	6.00	1.77	1.38	7/16-20	522140	231.38
CT50	1/2	8.00	1.48	1.38	7/16-20	522142	265.00
CT50	5/8	1.75*	1.77	1.65	9/16-18	522148	180.95
CT50	5/8	3.00	1.77	1.65	9/16-18	522150	202.70
CT50	5/8	4.00	1.77	1.65	9/16-18	522152	231.38
CT50	5/8	6.00	1.61	1.65	9/16-18	522154	231.38
CT50	3/4	1.75*	2.76	1.89	5/8-18	522158	202.70
CT50	3/4	3.00	2.76	1.89	5/8-18	522160	202.70
CT50	3/4	4.00	2.76	1.89	5/8-18	522162	231.38
CT50	3/4	6.00	2.76	1.89	5/8-18	522164	231.38
CT50	3/4	8.00	2.76	1.89	5/8-18	522166	265.00
CT50	1	2.00*	2.32	2.36	3/4-16	522176	202.70
CT50	1	4.00	3.54	2.36	3/4-16	522178	231.38
CT50	1	6.00	3.54	2.36	3/4-16	522180	231.38
CT50	1	8.00	3.54	2.36	3/4-16	522182	239.29
CT50	1	12.00	2.36	2.36	3/4-16	522183	600.95
CT50	1-1/4	2.00*	2.56	2.75	3/4-16	522186	202.70
CT50	1-1/4	4.00	3.54	2.48	3/4-16	522188	236.32
CT50	1-1/4	6.00	3.54	2.48	3/4-16	522190	239.29
CT50	1-1/2	2.25*	2.83	2.75	3/4-16	522196	202.70
CT50	1-1/2	4.50	3.15	2.99	3/4-16	522198	248.19
CT50	2	3.63*	3.66	3.74	1-14	522204	236.32
CT50	2	5.37	4.13	3.74	1-14	522206	248.19
CT50	2	8.00	4.13	3.74	1-14	522208	578.45
CT50	2	10.00	4.13	3.74	1-14	522210	642.72

\* Stubby Length

## BT30 End Mill Holders



- All ground body, bore, nose, flange
- TIR, 0.0001" / 0.003mm OD to ID
- AT2 Taper Accuracy
- Certified Steel
- RFID chip hole

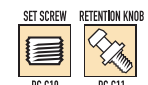
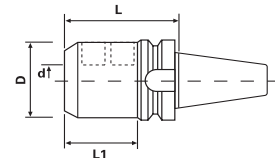

**PREMIUM BALANCE**  
**G6.3 at 30,000rpm**  
**CERTIFICATE INCLUDED**

Taper	Hole Dia. (d)	Gauge Length (L)	L1	D	Set Screw	Code No.	Price \$
BT30	1/8	2.36	0.59	0.75	8-32	532001	105.03
BT30	3/16	2.36	0.79	0.75	10-32	532003	105.03
BT30	1/4	2.36	1.18	0.79	1/4-28	532000	105.03
BT30	5/16	2.36	1.18	0.87	5/16-24	532002	105.03
BT30	3/8	2.36	1.18	1.00	3/8-24	532004	105.03
BT30	7/16	2.36	1.50	1.38	7/16-20	532006	105.03
BT30	1/2	2.36	2.95	1.38	7/16-20	532008	105.03
BT30	5/8	2.50	1.61	1.65	9/16-18	532010	105.03
BT30	3/4	3.00	1.77	1.88	5/8-18	532012	105.03
BT30	7/8	3.54	2.09	2.00	5/8-18	532014	117.27
BT30	1	3.54	2.32	2.36	3/4-16	532016	117.27

## BT30 DIRECT COOLANT End Mill Holders



### NOW 2 COOLANT OPTIONS ALL IN ONE!

- Coolant through the spindle
- Coolant through the body
- All ground body, bore, nose, flange
- TIR, 0.0001" / 0.003mm OD to ID
- AT2 Taper Accuracy
- Certified Steel
- RFID chip hole

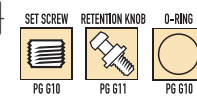
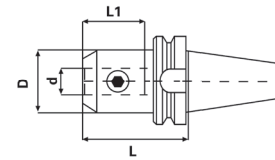
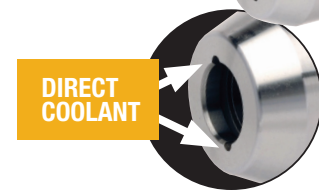

**PREMIUM BALANCE**  
**G6.3 at 30,000rpm**  
**CERTIFICATE INCLUDED**

Taper	Hole Dia. (d)	Gauge Length (L)	L1	D	Set Screw	Code No.	Price \$
BT30	1/4	2.36	1.10	0.79	1/4-28	522218	115.89
BT30	5/16	2.36	1.26	0.87	5/16-24	522220	115.89
BT30	3/8	2.36	1.26	1.00	3/8-24	522222	115.89
BT30	1/2	2.36	1.50	1.38	7/16-20	522224	115.89
BT30	3/4	3.00	1.77	1.88	5/8-18	522228	115.89

Tool Holding