

CAT Taper Jacobs Taper Adapter

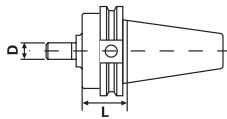

- Shank traverse ground to obtain optimum accuracy
- Meets or exceeds ANSI specifications
- 0.0002" or better ensures the best possible cutting tool life



Taper	JT Size	L	D	Code No.	Price \$
CT40	JT#2	1.61	0.560	531490	112.17
CT40	JT#3	1.58	0.812	531492	112.17
CT40	JT#4	1.49	1.13	531494	112.17
CT40	JT#6	1.61	0.677	531496	112.17
CT40	JT#33	1.61	0.625	531498	112.17
CT50	JT#2	1.61	0.560	531500	163.15
CT50	JT#3	1.58	0.812	531502	163.15
CT50	JT#4	1.49	1.13	531504	163.15
CT50	JT#6	1.61	0.677	531506	163.15
CT50	JT#33	1.61	0.625	531508	163.15

BT Taper Jacobs Taper Adapter

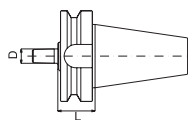

Taper	JT Size	L	D	Code No.	Price \$
BT30	JT#6	1.02	0.677	532224	98.91
BT40	JT#2	1.61	0.560	532230	111.15
BT40	JT#3	1.57	0.812	532232	111.15
BT40	JT#6	1.61	0.677	532234	111.15
BT40	JT#33	1.61	0.625	532236	111.15
BT50	JT#6	1.77	0.677	532237	175.39

NMTB Taper Jacobs Taper Adapter

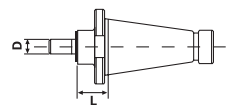

Taper	JT Size	L	D	Code No.	Price \$
NMTB40	JT#2	0.65	0.560	534442	113.40
NMTB40	JT#3	0.61	0.812	534444	113.40
NMTB40	JT#6	0.65	0.677	534446	113.40
NMTB40	JT#33	0.65	0.625	534448	113.40
NMTB50	JT#3	1.30	0.812	534452	158.32
NMTB50	JT#4	1.22	0.1.13	534454	158.32

R8 Jacobs Taper Adapter

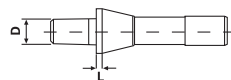

Taper	JT Size	L	D	Code No.	Price \$
R8	JT#2	0.13	0.560	534462	77.81
R8	JT#3	0.13	0.812	534464	77.81
R8	JT#6	0.13	0.677	534466	77.81
R8	JT#33	0.13	0.625	534468	77.81

CAT Morse Taper Adapters



- Shank traverse ground to obtain optimum accuracy
- Meets or exceeds ANSI specifications
- 0.0002" or better ensures the best possible cutting tool life

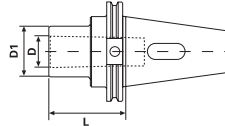

Taper	Size	L	D	D1	Code No.	Price \$
CT40	MT#1	1.75	0.475	1.00	531510	127.46
CT40	MT#2	2.36	0.700	1.25	531512	127.46
CT40	MT#3	3.00	0.938	1.57	531514	137.66
CT40	MT#4	3.54	1.23	1.97	531516	144.80
CT50	MT#2	1.75	0.700	1.25	531518	187.62
CT50	MT#3	1.75	0.938	1.57	531520	187.62
CT50	MT#4	3.00	1.23	1.97	531522	191.70
CT50	MT#5	4.13	1.75	2.75	531524	221.27

BT Morse Taper Adapters



- Shank traverse ground to obtain optimum accuracy
- Meets or exceeds ANSI specifications
- 0.0002" or better ensures the best possible cutting tool life

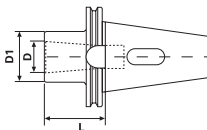

Taper	Size	L	D	D1	Code No.	Price \$
BT30	MT#1	1.75	0.475	1.00	532238	120.32
BT40	MT#1	1.75	0.475	1.00	532242	142.76
BT40	MT#2	2.36	0.700	1.25	532244	142.76
BT40	MT#3	3.00	0.938	1.57	532246	138.68
BT40	MT#4	3.54	1.23	1.97	532248	142.76
BT50	MT#2	1.75	0.700	1.25	532241	210.06
BT50	MT#3	1.75	0.928	1.57	532243	210.06
BT50	MT#4	3.00	1.231	1.89	532245	237.59
BT50	MT#5	4.00	1.748	2.48	532247	241.67

NMTB Morse Taper Adapters

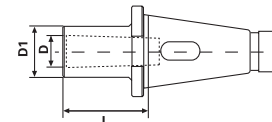

Taper	Size	L	D	D1	Code No.	Price \$
NMTB40	MT#2	1.75	0.70	1.25	534472	121.42
NMTB40	MT#3	2.25	0.94	1.57	534474	121.42
NMTB40	MT#4	3.00	1.23	1.97	534476	121.42
NMTB50	MT#2	1.88	0.70	1.25	534478	178.71
NMTB50	MT#3	2.38	0.94	1.57	534480	184.02
NMTB50	MT#4	3.25	1.23	1.97	534482	189.31
NMTB50	MT#5	4.63	1.75	2.75	534484	207.12

R8 Morse Taper Adapters

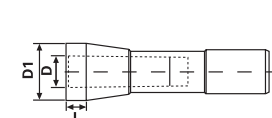

Taper	Size	L	D	D1	Code No.	Price \$
R8	MT#1	0.44	0.48	1.00	534486	80.16
R8	MT#2	0.44	0.70	1.25	534488	80.16
R8	MT#3	2.56	0.94	1.57	534490	88.05