

BT40 End Mill Holders

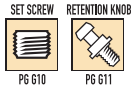

- DIN coolant option - standard
- All ground body, bore, nose, flange
- TIR, 0.0001" / 0.003mm OD to ID
- AT2 Taper Accuracy
- Certified Steel
- RFID chip hole

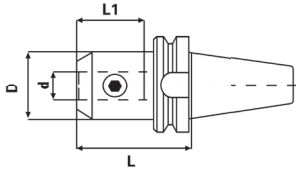

PREMIUM BALANCE
G6.3 at 30,000rpm
CERTIFICATE INCLUDED

Taper	Hole Dia. (d)	Gauge Length (L)	L1	D	Set Screw	Code No.	Price \$
BT40	1/8	1.38*	0.59	1.75	8-32	531019	108.09
BT40	1/8	2.50	0.59	0.75	8-32	531021	130.52
BT40	1/8	4.00	0.59	0.75	8-32	531023	165.19
BT40	3/16	1.38*	0.79	0.75	10-32	531025	108.09
BT40	3/16	2.50	0.79	0.75	10-32	531027	130.52
BT40	3/16	4.00	0.79	0.75	10-32	531029	165.19
BT40	1/4	1.38*	1.18	0.79	1/4-28	532018	130.52
BT40	1/4	2.50	1.18	0.79	1/4-28	532020	130.52
BT40	1/4	4.00	1.18	0.79	1/4-28	532022	165.19
BT40	5/16	1.38*	1.18	0.87	5/16-24	532024	130.52
BT40	5/16	2.50	1.18	0.87	5/16-24	532026	130.52
BT40	5/16	4.00	1.18	0.87	5/16-24	532028	165.19
BT40	3/8	1.38*	1.57	1.00	3/8-24	532030	130.52
BT40	3/8	2.50	1.57	1.00	3/8-24	532032	130.52
BT40	3/8	4.00	1.57	1.00	3/8-24	532034	165.19
BT40	7/16	2.50	1.50	1.38	7/16-20	532036	130.52
BT40	1/2	1.75*	1.50	1.38	7/16-20	532038	130.52
BT40	1/2	2.50	2.56	1.38	7/16-20	532040	130.52
BT40	1/2	4.00	2.56	1.38	7/16-20	532042	165.19
BT40	5/8	1.75*	1.97	1.65	9/16-18	532044	130.52
BT40	5/8	2.50	2.76	1.65	9/16-18	532046	130.52
BT40	5/8	4.00	3.50	1.65	9/16-18	532048	165.19
BT40	3/4	1.75*	2.01	1.89	5/8-18	532050	130.52
BT40	3/4	2.50	2.56	1.89	5/8-18	532052	130.52
BT40	3/4	4.00	2.56	1.89	5/8-18	532054	165.19
BT40	7/8	3.38	4.06	2.00	5/8-18	532056	169.27
BT40	7/8	6.00	2.08	2.00	5/8-18	532058	175.39
BT40	1	2.00*	2.32	2.25	3/4-16	532060	169.27
BT40	1	3.56	3.54	2.36	3/4-16	532062	169.27
BT40	1	6.00	3.54	2.36	3/4-16	532064	175.39
BT40	1-1/4	2.00*	2.36	2.25	3/4-16	532066‡	175.39
BT40	1-1/4	3.56	3.54	2.48	3/4-16	532068	175.39
BT40	1-1/4	6.00	3.54	2.48	3/4-16	532070	214.14
BT40	1-1/2	4.50	3.15	2.99	3/4-16	532072	175.39
BT40	1-1/2	6.00	3.15	2.99	3/4-16	532074	214.14

* Stubby Length

‡ Not DIN Coolant

BT40 DIRECT COOLANT End Mill Holders



NOW 3 COOLANT OPTIONS ALL IN ONE!

- Coolant through the spindle
- DIN coolant through flange option
- Coolant through the body
- All ground body, bore, nose, flange
- TIR, 0.0001" / 0.003mm OD to ID
- AT2 Taper Accuracy
- Certified Steel
- RFID chip hole



DIRECT COOLANT

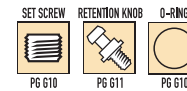
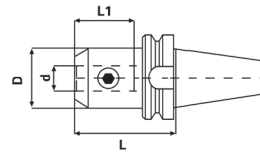

PREMIUM BALANCE
G6.3 at 30,000rpm
CERTIFICATE INCLUDED

Taper	Hole Dia. (d)	Gauge Length (L)	L1	D	Set Screw	Code No.	Price \$
BT40	1/4	4.00	1.10	0.79	1/4-28	522246	186.73
BT40	3/8	2.50	1.57	1.00	3/8-24	522256	185.19
BT40	3/8	4.00	1.57	1.00	3/8-24	522258	186.73
BT40	1/2	2.50	2.56	1.38	7/16-20	522264	186.73
BT40	1/2	4.00	2.56	1.38	7/16-20	522266	186.73
BT40	3/4	2.50	2.56	1.89	5/8-18	522276	186.73
BT40	3/4	4.00	2.56	1.89	5/8-18	522278	186.73
BT40	1	2.00*	2.32	2.25	3/4-16	522282	185.19

BT50 End Mill Holders



- DIN coolant option - standard
- All ground body, bore, nose, flange
- TIR, 0.0001" / 0.003mm OD to ID
- AT2 Taper Accuracy
- Certified Steel
- RFID chip hole

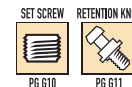
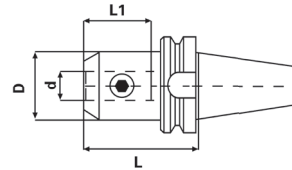

PREMIUM BALANCE
G6.3 at 25,000rpm
CERTIFICATE INCLUDED

Taper	Hole Dia. (d)	Gauge Length (L)	L1	D	Set Screw	Code No.	Price \$
BT50	3/8	2.50	1.57	1.00	3/8-24	532075	299.79
BT50	3/8	5.31	1.57	1.00	3/8-24	532076	433.37
BT50	1/2	2.75	1.77	1.38	7/16-20	532077	299.79
BT50	1/2	5.31	1.77	1.38	7/16-20	532078	433.37
BT50	5/8	3.00	1.77	1.65	9/16-18	532079	299.79
BT50	5/8	5.31	1.77	1.65	9/16-18	532081	433.37
BT50	3/4	3.00	2.76	1.75	5/8-18	532083	299.79
BT50	3/4	6.00	3.82	1.75	5/8-18	532085	433.37
BT50	1	4.00	4.21	2.36	3/4-16	532087	299.79
BT50	1	6.00	3.54	2.36	3/4-16	532089	453.77
BT50	1-1/4	4.00	3.54	2.48	3/4-16	532091	299.79
BT50	1-1/4	6.00	3.54	2.48	3/4-16	532093	463.96
BT50	1-1/2	4.13	3.15	2.99	3/4-16	532095	474.16
BT50	1-1/2	7.00	3.15	2.99	3/4-16	532097	535.34
BT50	2	4.72	4.13	3.86	1-14	532099	474.16