

Workholding, Clamping & Fixturing

Machinable Fixture Jaws

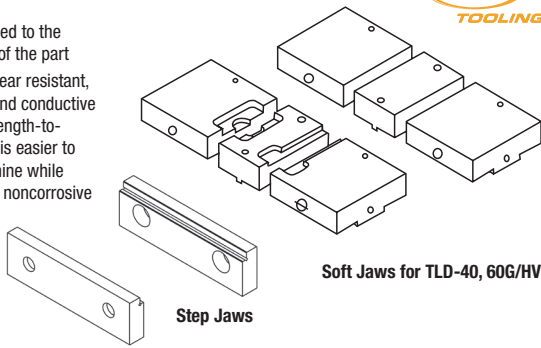

- Can be machined to the precise shape of the part
- Aluminum is wear resistant, nonmagnetic and conductive with a high strength-to-weight ratio. It is easier to form and machine while being naturally noncorrosive



Description	Code No.	Price \$
4" aluminum soft jaws	382612	539.75
4" step jaws	382614	243.20
6" aluminum soft jaws (10mm key)	382602	824.69
6" aluminum soft jaws (14mm key)	382609	824.69
6" step jaws	382604	279.09

Steel Jaw Plate Set



Steel offers high tensile strength and corrosion resistance.



Description	Code No.	Price \$
6" steel jaw plate set (4pcs) for TLD60	382617	310.37

Steel Jaw Sets



Steel offers high tensile strength and corrosion resistance.



Description	Code No.	Price \$
4" steel jaw set for TLD40	382615	369.43
6" steel jaw set for TLD60	382605	468.22

Standard Accessories

Usage of "Plate"

Optional Accessories

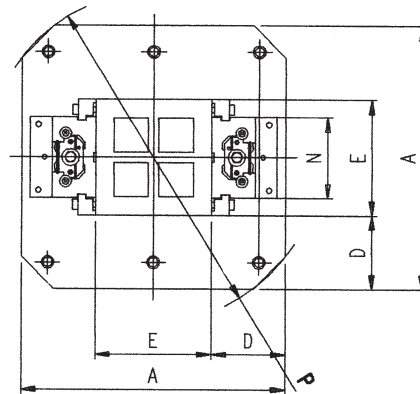
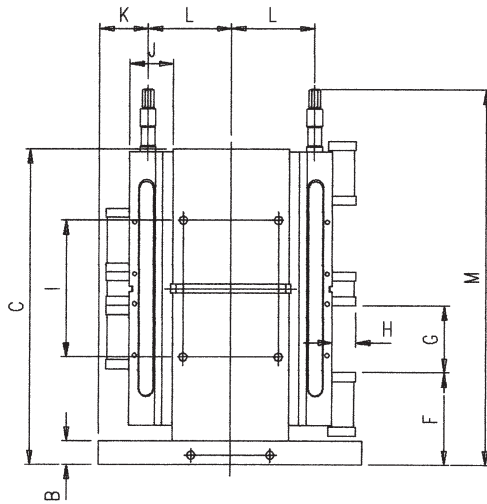
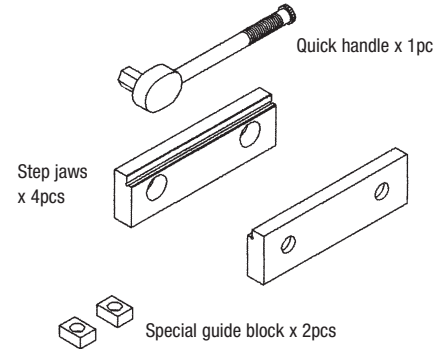
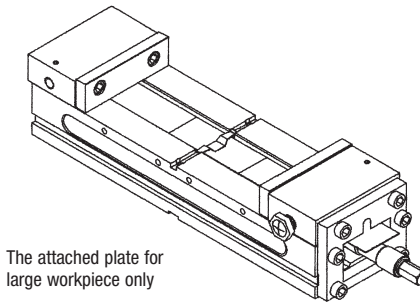
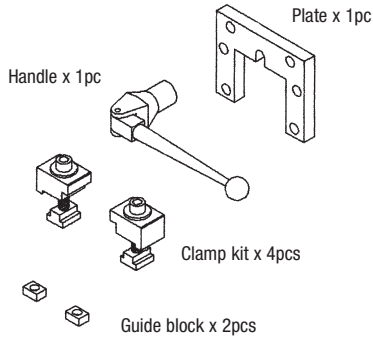

Jig Block Dimensional Specifications

(mm/in.)

Model NO.	Use Vise	Pallet Size	A	B	C	D	E	F	G	H	I	J	K	L	M	N	P	Weight (kg/lb)
GS-40-4C	TLD-40	400 x 400	400	40	500	110	180	168	90	38	203	63.5	75.5	124.5	543	104	506	118
GS-40-4C	TLD-40	400 x 400	15.74	1.57	19.68	4.33	7.08	6.61	3.54	1.49	7.99	2.5	2.907	4.90	21.3	4.09	19.92	259.6
GS-60-4C	TLD-60	500 x 500	500	45	600	140	220	175	125	44.5	260	82.5	92	158	714	154	628	233
GS-60-4C	TLD-60	500 x 500	19.68	1.77	23.62	5.51	8.66	6.88	4.92	1.75	10.23	3.25	3.62	6.25	28.11	6.02	24.72	512.6