

NEW



HOLDERS NOW AVAILABLE!

The perfect economic tooling solution for general purpose machining applications.



Taper Accuracy	AT3 or better (ANSI B5.50)
Runout Accuracy	0.0002"
Manufacturing Process	Precision ground
Balance	CAT40 End Mill Holders: Balanced to G2.5 / 8,000 rpm CAT50 End Mill Holders: Balanced to G2.5 / 6,000 rpm CAT40 Collet Chucks: Balanced to G2.5 / 20,000 rpm CAT50 Collet Chucks: Balanced to G2.5 / 15,000 rpm
Coolant Features	AD/B DIN coolant through flange
SKU Offering	CAT40 & CAT50 End Mill Holders & Collet Chucks

STM End Mill Holders

- AD/B DIN coolant through flange - standard
- Factory balanced to save spindle life, tool life and increased productivity
- Threaded through holes for a back-up screw (tool stop) or coolant through when removed
- TIR, 0.0002" OD to ID
- CAT40 Balanced to G2.5 / 8,000 rpm
- CAT50 Balanced to G2.5 / 6,000 rpm
- Complete with calibration certificate

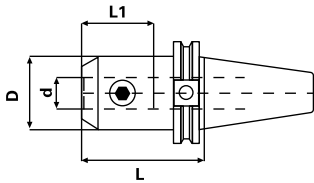

STM ER Collet Chucks

- AD/B DIN coolant through flange - standard
- Factory balanced to save spindle life, tool life and increased productivity
- Threaded through holes for a back-up screw (tool stop) or coolant through when removed
- TIR, 0.0002" at 4xDia.
- CAT40 Balanced to G2.5 / 20,000 rpm
- CAT50 Balanced to G2.5 / 15,000 rpm
- Complete with calibration certificate

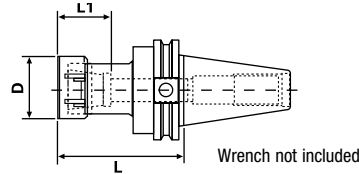

STM CAT40 End Mill Holders

Taper	Hole Dia. (d)	Gauge Length (L)	L1	D	Set Screw	Code No.	Reg. Price \$
CT40	1/8"	2.50"	0.63"	0.75"	8-32	525070	87.68
CT40	1/8"	4.00"	0.63"	0.75"	8-32	525071	87.68
CT40	3/16"	2.50"	0.86"	0.75"	10-32	525073	87.68
CT40	3/16"	4.00"	0.86"	0.75"	10-32	525074	87.68
CT40	1/4"	2.50"	1.10"	0.79"	1/4-28	525002	87.68
CT40	1/4"	4.00"	1.10"	0.79"	1/4-28	525004	87.68
CT40	5/16"	2.50"	1.26"	0.87"	5/16-24	525008	87.68
CT40	3/8"	2.50"	1.26"	1.00"	3/8-24	525014	87.68
CT40	3/8"	4.00"	1.26"	1.00"	3/8-24	525016	87.68
CT40	1/2"	1.75"*	1.50"	1.38"	7/16-20	525024	87.68
CT40	1/2"	2.50"	1.50"	1.38"	7/16-20	525026	87.68
CT40	1/2"	4.00"	1.50"	1.38"	7/16-20	525028	87.68
CT40	5/8"	1.75"*	1.61"	1.65"	9/16-18	525032	87.68
CT40	5/8"	3.00"	1.61"	1.65"	9/16-18	525034	87.68
CT40	3/4"	1.75"*	1.77"	1.89"	5/8-18	525040	87.68
CT40	3/4"	3.00"	1.77"	1.75"	5/8-18	525042	87.68
CT40	1"	2.00"*	2.36"	2.25"	3/4-16	525054	87.68
CT40	1"	4.00"	2.36"	2.36"	3/4-16	525056	87.68
CT40	1-1/4"	2.00"*	2.28"	2.25"	3/4-16	525060 ‡	87.68

* Stubby Length

‡ Not DIN Coolant

STM CAT50 End Mill Holders

Taper	Hole Dia. (d)	Gauge Length (L)	L1	D	Set Screw	Code No.	Reg. Price \$
CT50	1/2"	4.00"	1.50"	1.38"	7/16-20	525120	110.37
CT50	3/4"	4.00"	1.77"	1.89"	5/8-18	525140	110.37
CT50	1"	4.00"	2.36"	2.36"	3/4-16	525154	133.06
CT50	1-1/4"	4.00"	2.55"	2.48"	3/4-16	525162	133.06

STM CAT40 ER Collet Chucks

Taper	Collet Series	Collet Range	L	L1	D	Code No.	Reg. Price \$
CT40	ER11*	0.019-0.275"	2.50"	0.65"	0.75"	525400	81.49
CT40	ER11*	0.019-0.275"	4.00"	0.65"	0.75"	525402	87.68
CT40	ER11*	0.019-0.275"	6.00"	0.65"	0.75"	525404	110.37
CT40	ER16*	0.019-0.413"	2.50"	0.87"	1.26"	525406	81.49
CT40	ER16*	0.019-0.413"	3.50"	0.87"	1.26"	525408	87.68
CT40	ER16*	0.019-0.413"	4.00"	0.87"	1.26"	525405	87.68
CT40	ER16*	0.019-0.413"	6.00"	0.87"	1.26"	525410	110.37
CT40	ER20*	0.019-0.551"	2.50"	1.06"	1.38"	525412	81.49
CT40	ER20*	0.019-0.551"	4.00"	1.06"	1.38"	525414	87.68
CT40	ER20*	0.019-0.551"	6.00"	1.06"	1.38"	525416	110.37
CT40	ER25	0.059-0.675"	2.50"	1.18"	1.65"	525418	81.49
CT40	ER25	0.059-0.675"	4.00"	1.18"	1.65"	525420	87.68
CT40	ER32	0.078-0.787"	2.50"	1.34"	1.97"	525421	81.49
CT40	ER32	0.078-0.787"	3.13"	1.34"	1.97"	525424	81.49
CT40	ER32	0.078-0.787"	4.00"	1.34"	1.97"	525423	87.68
CT40	ER32	0.078-0.787"	6.00"	1.34"	1.97"	525425	110.37

* Hex Nut

STM CAT50 ER Collet Chucks

Taper	Collet Series	Collet Range	L	L1	D	Code No.	Reg. Price \$
CT50	ER16*	0.019-0.413"	4.12"	0.87"	1.26"	525432	115.53
CT50	ER16*	0.019-0.413"	6.00"	0.87"	1.26"	525434	139.25
CT50	ER20*	0.019-0.551"	4.00"	1.06"	1.38"	525440	115.53
CT50	ER20*	0.019-0.551"	6.00"	1.06"	1.38"	525442	139.25
CT50	ER32	0.078-0.787"	4.00"	1.34"	1.97"	525454	115.53
CT50	ER32	0.078-0.787"	6.00"	1.34"	1.97"	525456	139.25

* Hex Nut